

# neon effect LED wall art

(PLUG NOT INCLUDED)

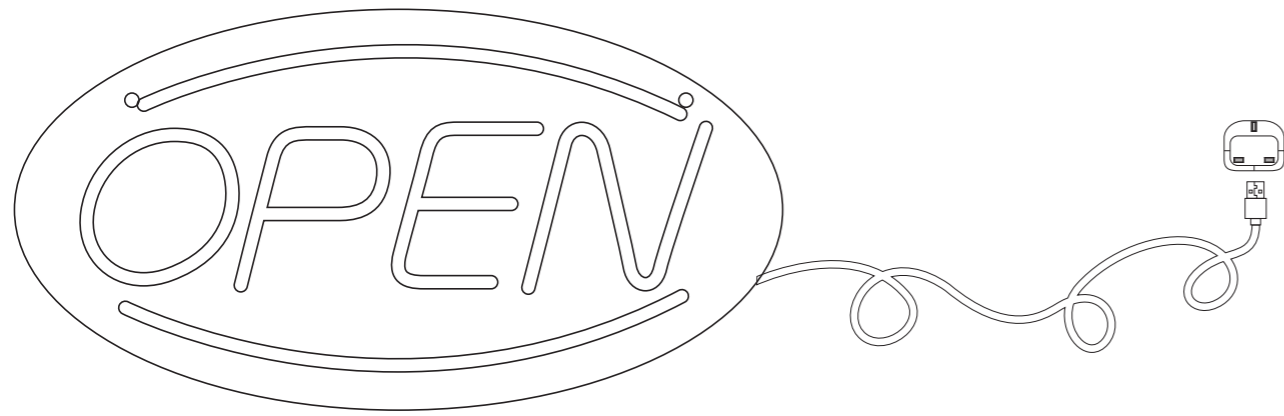

## FITTING TO WALL (FIXTURES NOT INCLUDED)

- 1) MAKE SURE YOU USE THE CORRECT SIZE SCREWS AND WALL PLUGS.
- 2) HOLD THE LED WALL ART AGAINST THE WALL AND POSITION IN PLACE MAKING SURE THE CABLE REACHES A PLUG SOCKET. USING A PENCIL MARK THE WALL WHERE THE SCREWS ARE TO BE FIXED.
- 3) TAKE CARE TO AVOID CABLES, PIPES AND OTHER OBSTRUCTIONS. FIX SCREWS INTO THE WALL. HANG YOUR LED WALL ART ON THE SCREWS.

**⚠ WARNING: CHOKING HAZARD**  
Contains small parts. Not suitable for children under 14 years  
**FOR ADULT USE ONLY**



Electronic devices are valuable materials and at the end of their useful life should not be disposed of with household waste! Help us to protect the environment and safeguard our resources by discarding this equipment at a dedicated recycling point. The authority responsible for waste disposal or your retailer will be able to answer any questions you may have regarding this.

For wall mounting please follow the instructions below:

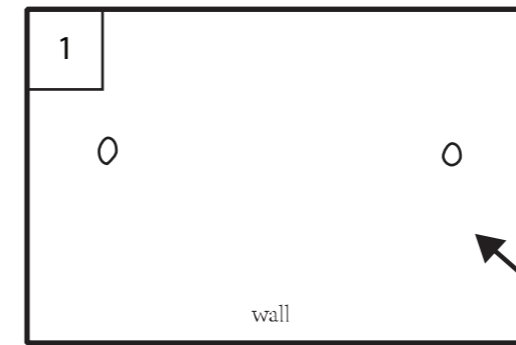

### IMPORTANT

Before installation check that there are no electrical cables or buried gas or water pipes in the wall. If in doubt seek professional advice.

Place the wall art onto the wall in the desired position ensuring it is level. Please note : The product has a cable length of 190cm and plugs into a standard wall socket. Using the wall art as a template mark the position of the 2 holes.

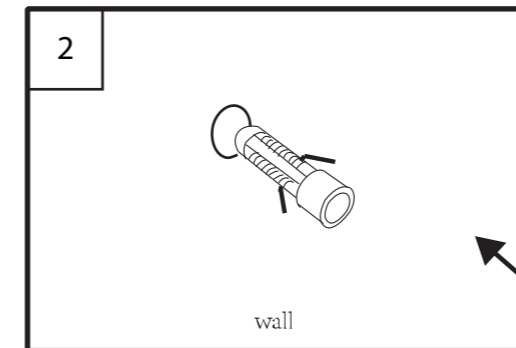

Drill 2 holes into the wall. Insert 2 plastic wall plugs into the holes.

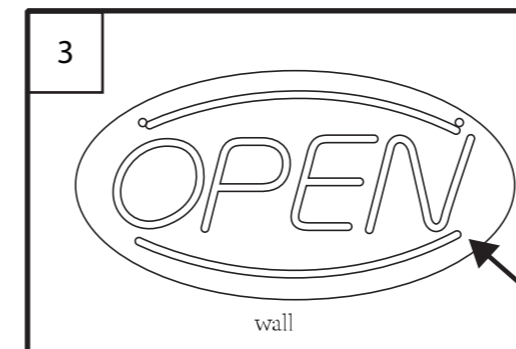

Align the wall art with the screws.

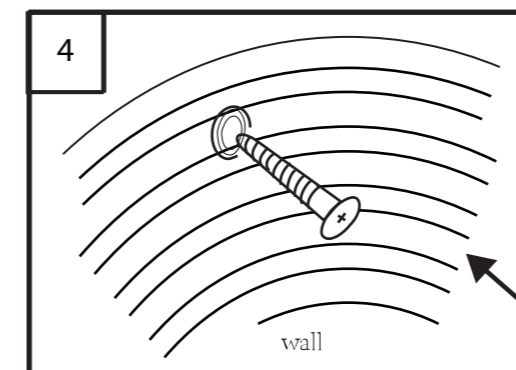

Securely attach 2 screws into the wall plugs.