

EXPLODED VIEW

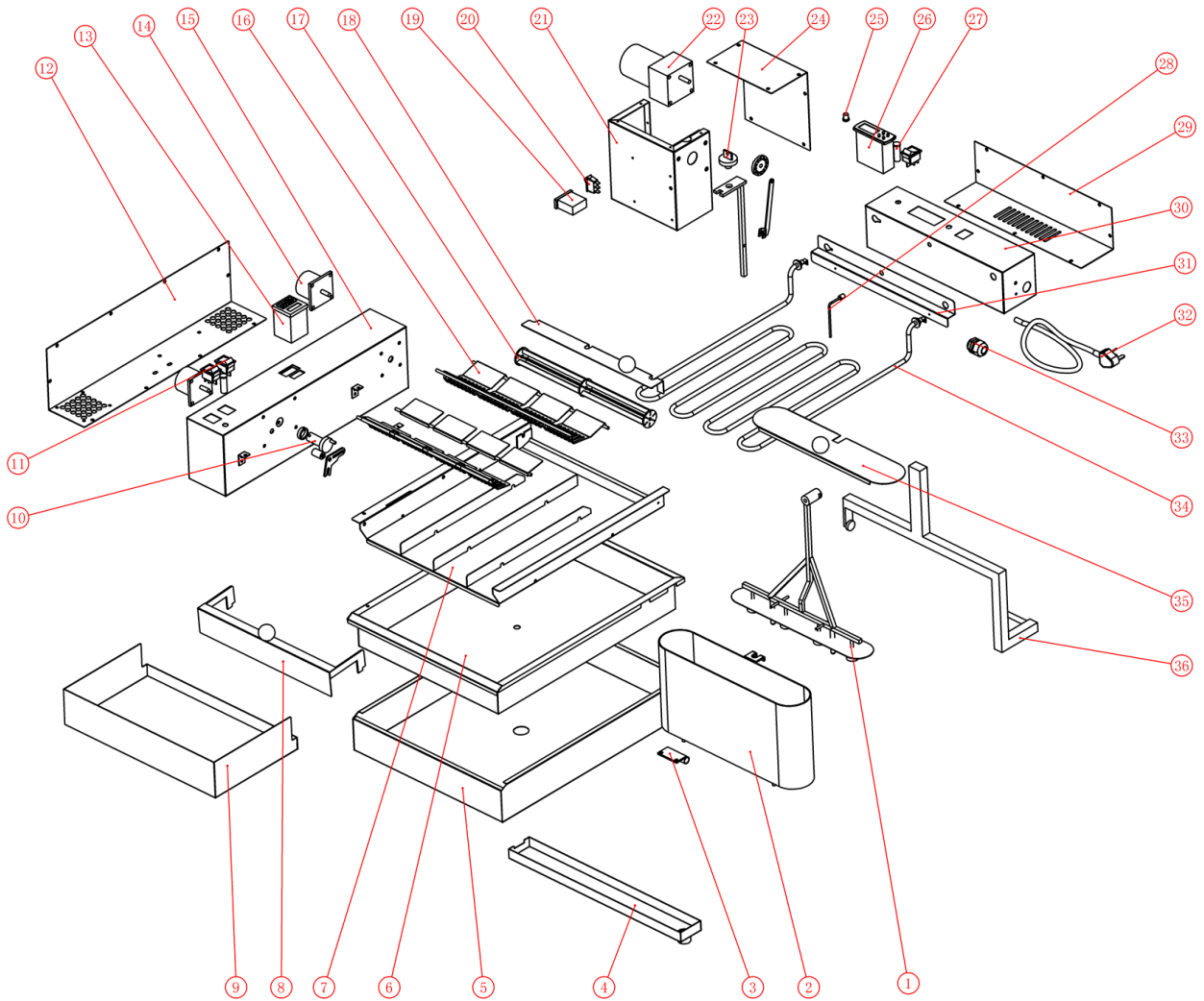

NO.	SPARE PART NAME	QUANTITY
1	Pressure	1
2	tanks	1
3	stator	1
4	oil guide	1
5	base	1
6	oil tank	1
7	lead rail box	1
8	baffle	1
9	box	1
10	Motor shaft	1
11	switch	3
12	side plate	1
13	timer	1
14	motor	1
15	Control panel transmission components	1
16	Flip food parts	1
17	Flip oils parts	1
18	Oil baffle plate	1
19	counter	1
20	dropping switch	1
21	dropping control panel	1
22	dropping Motor	1
23	dropping components	1
24	dropping back seal plate	1
25	temperature limiter	1
26	Thermostat	1
27	light	2
28	Temperature probe	1
29	back seal plate	1
30	Control panel heating components	1
31	Heating tube fixed plate	1
32	power cord	1
33	PG16 lead-out bushing	1
34	Heat pipes	1
35	lid	1
36	dropping mounting bracket	1