

ggm gastro

INTERNATIONAL

EWI212VH

FEATURES CARACTERÍSTICAS

- ▶ **PRODUCES FULL DICE ICE CUBES OR HALF DICE ICE CUBES**
PRODUCE CUBITOS DE DADO Y MEDIO DADO
- ▶ **HIGH EFFICIENT EVAPORATOR**
EVAPORADOR DE ALTA EFICIENCIA
- ▶ **SMART WATER DISTRIBUTOR THAT IMPROVES DROP-OFF EFFICIENCY**
DISTRIBUIDOR DE AGUA INTELIGENTE QUE MEJORA LA EFICIENCIA EN EL DESPEGUE
- ▶ **EASY ACCESS BY REMOVING THE PANELS WITH A SINGLE SCREWDRIVER**
FÁCIL ACCESO RETIRANDO LOS PANELES CON UN SOLO DESTORNILLADOR
- ▶ **SMART ELECTRONIC BOARD CONTROLS EVERY PARAMETER IN THE MACHINE AND SHOWS THE DIAGNOSIS OF POSSIBLE INCIDENCES**
PLACA ELECTRÓNICA INTELIGENTE QUE CONTROLA LOS PARÁMETROS DE LA MÁQUINA Y MUESTRA EL DIAGNÓSTICO DE POSIBLES INCIDENCIAS
- ▶ **NATURAL GAS R290 WITH VERY LOW GLOBAL WARMING POTENTIAL WHICH ALSO REDUCES THE ENERGY CONSUMPTION**
GAS NATURAL R290 CON MUY BAJO ÍNDICE GWP EL CUAL TAMBIÉN REDUCE EL CONSUMO ENERGÉTICO
- ▶ **ENERGY STAR, LOW POWER CONSUMPTION CERTIFICATION**
ENERGY STAR, CERTIFICADO DE BAJO CONSUMO ELÉCTRICO
- ▶ **HIGH RESISTANCE EXTERNAL FRAME IN AISI 304 STAINLESS STEEL**
ESTRUCTURA DE ALTA RESISTENCIA EN ACERO INOXIDABLE AISI 304

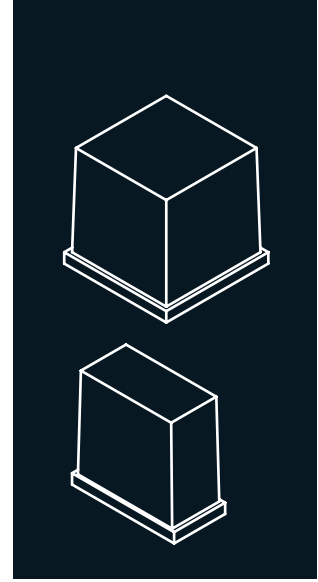

| | | 10°C (Kg) | 15°C (Kg) | (mm) | (mm) |
|----------|--|------------------|------------------|--------------------------------------|--------------------------------------|
| EWI212VH | | 225 | 207 | Width 762 Depth 620 Height 500 | Width 836 Depth 635 Height 625 |

ACCESSORIES ACCESORIOS

INCLUDED



WATER INLET FILTER GASKET
JUNTA DE FILTRO DE ENTRADA DE AGUA



WATER INLET HOSE
MANGUERA DE ENTRADA DE AGUA



WATER OUTLET HOSE
MANGUERA DE DESAGÜE

NOT INCLUDED (OPTIONAL)



ANTI-LIMESCALE FILTER
FILTRO ANTICAL



PARTICLE FILTER
FILTRO ANTIPARTÍCULAS



ANTI-LIMESCALE + ANTI-CHLORINE FILTER CS101
FILTRO ANTICAL + ANTICLORO CS101

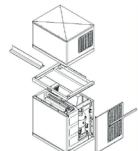

STACKING KIT
KIT APILADO

TECHNICAL SCHEME ESQUEMA TÉCNICO

EWI212VH

RIGHT SIDE VIEW
VISTA LATERAL DERECHA

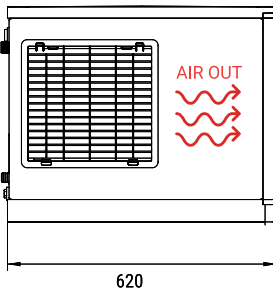

FRONTAL VIEW
VISTA FRONTAL

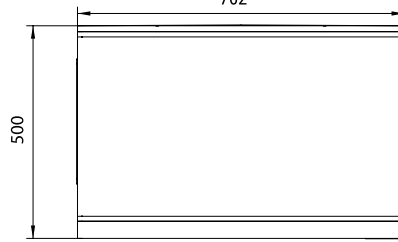

REAR VIEW
VISTA TRASERA

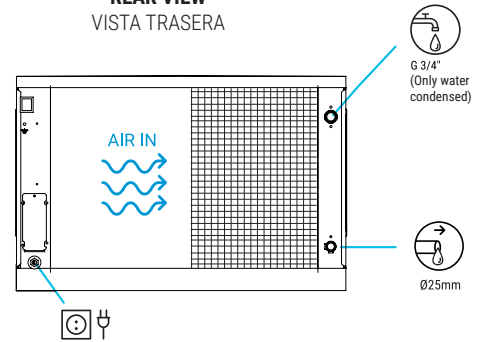

CENTRAL CROSS SECTION
VIEW OF THE BASE
VISTA DE LA BASE DESDE
SECCIÓN CENTRAL

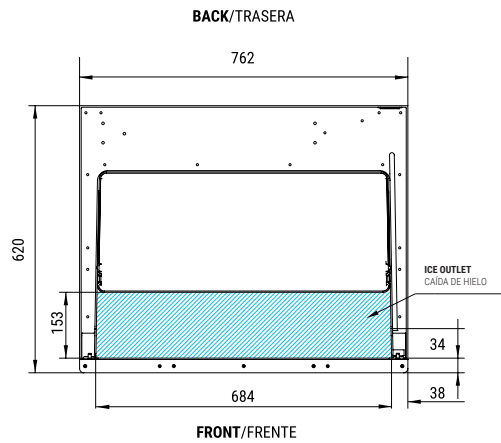

* All measurements in mm.
* Todas las cotas en mm.

OPERATING CONDITIONS CONDICIONES DE OPERACIÓN

PRODUCTION 50Hz PRODUCCIÓN 50 Hz

±10% V

10°C/43°C

5°C/38°C

1 bar/6 bar

200/400 Ice cubes/cycle

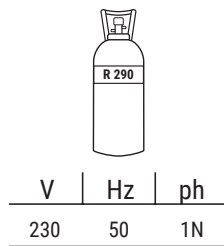

EWI212VH AIR COOLED

| °C | 10° | 15° | 21° | 30° |
|------|-----|-----|-----|-----|
| °F | 50° | 60° | 70° | 86° |
| 10° | 225 | 220 | 205 | 180 |
| 50° | | | | |
| 21° | 212 | 207 | 190 | 165 |
| 68° | | | | |
| 32° | 198 | 192 | 169 | 145 |
| 90° | | | | |
| 43° | 176 | 170 | 144 | 105 |
| 109° | | | | |

EWI212VH WATER COOLED

| °C | 10° | 15° | 21° | 30° |
|------|-----|-----|-----|-----|
| °F | 50° | 60° | 70° | 86° |
| 10° | - | - | - | - |
| 50° | | | | |
| 21° | - | - | - | - |
| 68° | | | | |
| 32° | - | - | - | - |
| 90° | | | | |
| 43° | - | - | - | - |
| 109° | | | | |

| EWI212VH | ASHRAE CONDITIONS CONDICIONES ASHRAE | ASHRAE CONDITIONS | | ASHRAE CONDITIONS | ASHRAE CONDITIONS | ASHRAE CONDITIONS | ASHRAE CONDITIONS | ASHRAE CONDITIONS | ASHRAE CONDITIONS | ASHRAE CONDITIONS | ASHRAE CONDITIONS | ASHRAE CONDITIONS | ASHRAE CONDITIONS | | |
|----------|---|-------------------|---------|-------------------|-------------------|-------------------|-------------------|-------------------|-------------------|-------------------|-------------------|-------------------|-------------------|----|------|
| | | (W) | (BTU/h) | | | | | | | | | | | | |
| | | 2.292 | 7820 | 795 | 3 | 2,5 | 16 | 10,3 | 11 | 12 | 1.747 | 5.961 | 85 | 93 | 0,38 |