

# EXPLODED VIEW

BTKG800GND

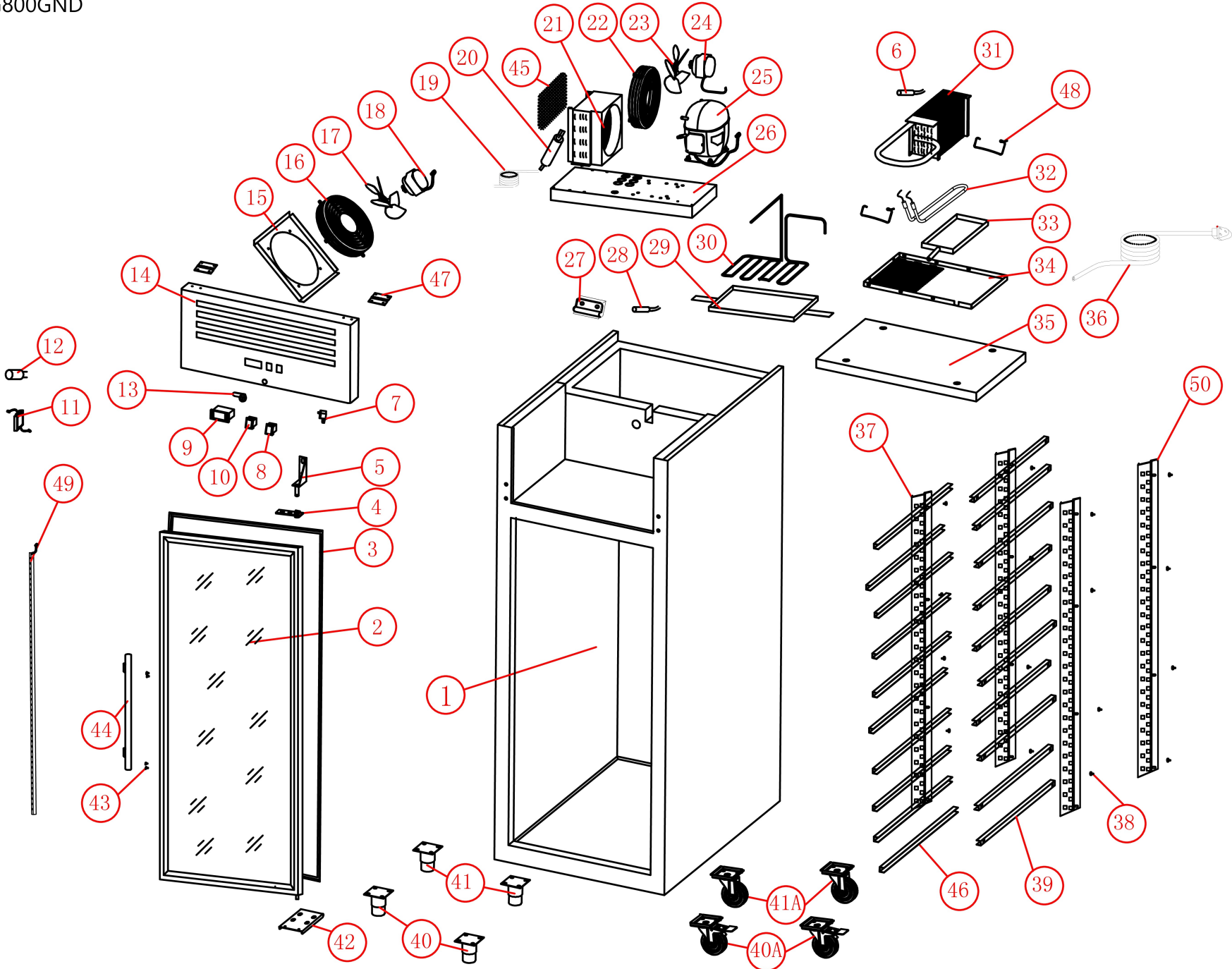

## BTKG800GND EXPLODE LIST

number	list	name	quantity
1	GX-PA800BTG-HC. 01	cabinet	1
2	GX-PA800BTG-HC. 02	right glass door	1
3	GX-PA800BTG-HC. 03	glass door gasket	1
4	GX-PA800BTG-HC. 04	door axis sleeve	1
5	GX-PA800BTG-HC. 05	right upper hinge	1
6	GX-PA800BTG-HC. 06	eva. sensor	1
7	GX-PA800BTG-HC. 07	light/fan switch	1
8	GX-PA800BTG-HC. 08	LED light switch	1
9	GX-PA800BTG-HC. 09	controller	1
10	GX-PA800BTG-HC. 10	power switch	1
11	GX-PA800BTG-HC. 11	LED light Power supply	1
12	GX-PA800BTG-HC. 12	glass door capacity	1
13	GX-PA800BTG-HC. 13	door lock	1
14	GX-PA800BTG-HC. 14	panel	1
15	GX-PA800BTG-HC. 15	motor board	1
16	GX-PA800BTG-HC. 16	eva. fan cover	1
17	GX-PA800BTG-HC. 17	eva. fan blade	1
18	GX-PA800BTG-HC. 18	eva. fan	1
19	GX-PA800BTG-HC. 19	capillary	1
20	GX-PA800BTG-HC. 20	dryer filter	1
21	GX-PA800BTG-HC. 21	condenser	1
22	GX-PA800BTG-HC. 22	cond.fan cover	1
23	GX-PA800BTG-HC. 23	cond. Fan blade	1
24	GX-PA800BTG-HC. 24	cond. Fan motor	1
25	GX-PA800BTG-HC. 25	compressor	1
26	GX-PA800BTG-HC. 26	cooling unit board	1
27	GX-PA800BTG-HC. 27	sensor clip	1
28	GX-PA800BTG-HC. 28	sensor	1
29	GX-PA800BTG-HC. 29	outer drain pan	1
30	GX-PA800BTG-HC. 30	high pressure pipe	1
31	GX-PA800BTG-HC. 31	evaporator	1
32	GX-PA800BTG-HC. 32	heater	1
33	GX-PA800BTG-HC. 33	inner drain pan	1
34	GX-PA800BTG-HC. 34	fan plate	1
35	GX-PA800BTG-HC. 35	top cover	1
36	GX-PA800BTG-HC. 36	power cord	1
37	GX-PA800BTG-HC. 37	front shelf holder	2
38	GX-PA800BTG-HC. 38	M6 bolt	16
39	GX-PA800BTG-HC. 39	right shelf guide	10
40	GX-PA800BTG-HC. 40	feet(optional)	2
53	GX-PA800BTG-HC. 40A	wheel(with lock)	2
41	GX-PA800BTG-HC. 41	feet(optional)	2
42	GX-PA800BTG-HC. 41A	wheel	2
43	GX-PA800BTG-HC. 42	right bottom hinge	1
44	GX-PA800BTG-HC. 43	door hand shank screw	4
45	GX-PA800BTG-HC. 44	glass door hand shank	1
46	GX-PA800BTG-HC. 45	cond. filter net	1
47	GX-PA800BTG-HC. 46	left shelf guide	10
48	GX-PA800BTG-HC. 47	panel connect	2
49	GX-PA800BTG-HC. 48	defrost heater clip	2
50	GX-PA800BTG-HC. 49	LED light	1
51	GX-PA800BTG-HC. 50	back shelf holder	2