

# GKS1500S

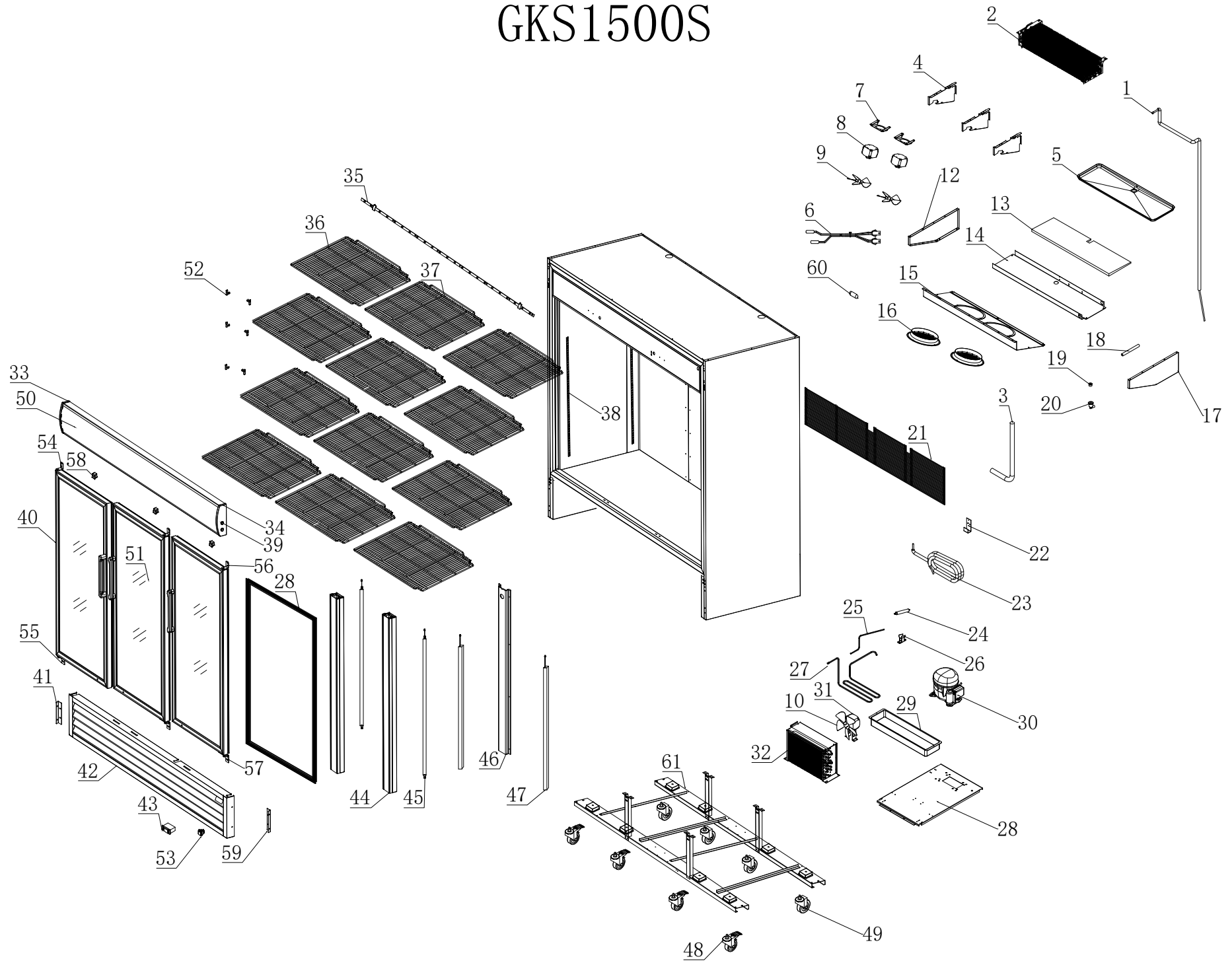

NO.	Name	Units
1	SC1780F return pipe A	1
2	SC1780F copper tube evaporator	1
3	drain	1
4	SD580 evaporator air baffle	3
5	SR81G evaporator water tray	1
6	Temperature sensing head, 4-wire, domestic double-terminal, 1000mm	1
7	SD580F evaporator fan fastener	2
8	EBM evaporation fan, 220V, 5W, special transfer	2
9	Evaporation fan blade 34 °	2
10	Condensing fan blade 34 °	1
11	LED-60W adapter	1
12	SD1180F evaporator air shell-left	1
13	SC1780F drain pan foam	1
14	SC1780 fan housing-Behind	1
15	SC1780 fan housing-front	1
16	Wind circle, white	2
17	SD1180F evaporator air shell-right	1
18	Drain pipe in the cabinet (water pipe is thickened)	1
19	27F cabinet drain pipe bolt	1
20	27F cabinet drain pipe nut	1
21	SC2090F engine room cover (black), 2037 * 309mm	1
22	27F return pipe reinforcement	1
23	SR81G return pipe B	1
24	Drying filter	1
25	Condenser-drying filter connecting pipe	1
26	25mm filter bracket	1
27	SD580F high-pressure pipe	1
28	SD1390FSD2090F door seal	3
29	27F unit water pan	2
30	Compressor, NUG120NA, Huayi	1
31	EBM condensing fan, 220V, 10W, special transfer	1
32	54F condenser	1
33	SD690F light box end stop left	1
34	SD1390F light box end stop right	1
35	SR81GLED light strip, 1800mm	1
36	SC1780F - left and right shelf	8
37	SC1780F - middle shelf	4
38	Hanging strip of rotary/American cabinet, 1000mm	12
39	Round switch, red, two-plug, without lamp	2
40	SC vertical expansion refrigerated plastic frame left door (without electric heating)	1
41	SR27G engine compartment front cover fastener left	1
42	SD2090F engine compartment front cover assembly	1
43	XRO4CX	1
44	SC1390F vertical beam assembly, black	2
45	SR54GLED flat tube light strip, vertical beam light strip, 1200mm	2
46	SR27G return pipe pressure plate	1
47	LED	2
48	2.5 inch caster (without brake)	4
49	2.5 inch caster (brake)	4
50	SR81G light box cover	1
51	SC vertical expansion refrigerated plastic frame right door (without electric heating)	2
52	Grid support, white	48
53	Green waterproof switch, 4-terminal, KCD2	1
54	SD1390F upper hinge - left	1
55	SD1390F lower hinge - left	1
56	SD1390F upper hinge - right	2
57	SD1390F lower hinge - right	2
58	Sector switch, HC-050K, three-plug	3
59	SR27G engine compartment front cover fastener right	1
60	Plastic heat head cover	1
61	SC1780F underframe assembly	1