

PZH2610TN

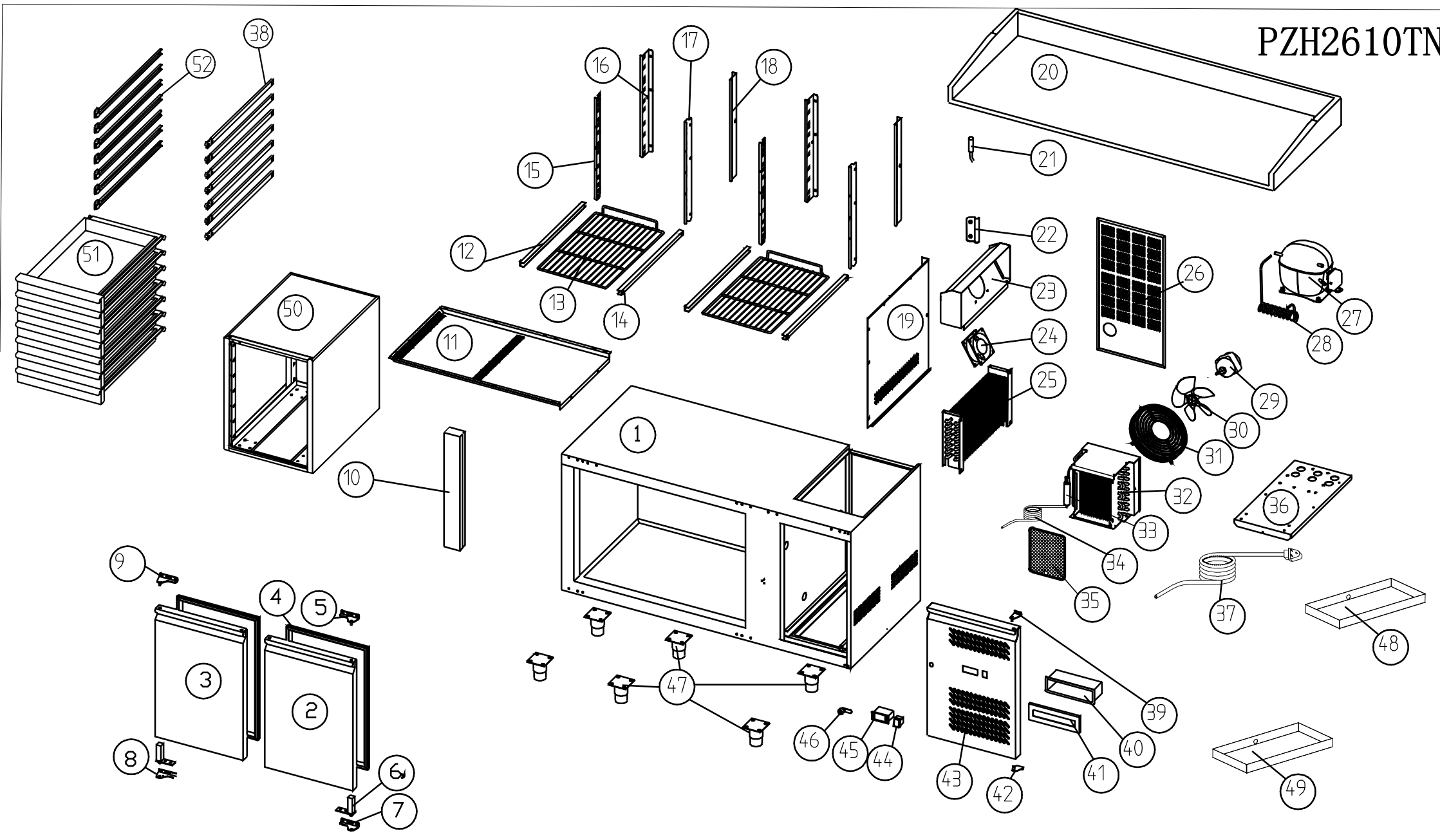

POS208SN (PZH2610TN) Spare parts list

S/N	Number		UNIT	QTY
1	SKC-0-000-0501-0	BODY	SET	1
2	SKC-0-000-0046-0	DOOR/RIGHT	SET	1
3	SKC-0-000-0044-0	DOOR/LEFT	SET	1
4	SKC-2-110-0043-0	GASKET	PCS	2
5	SKC-2-001-0531-0	UP HINGE/RIGHT	PCS	1
6	SKC-2-170-0210-0	DOOR SPRING	PCS	2
7	SKC-2-001-6070-0	Down HINGE/RIGHT	PCS	1
8	SKC-2-001-6068-0	Down HINGE/LEFT	PCS	1
9	SKC-2-001-0530-0	UP HINGE/LEFT	PCS	1
10	SKC-0-000-0028-0	FIXED FRONT PANEL	SET	1
11	SKC-2-003-1017-0	AIR FLOW CINDUCT BOARD	PCS	1
12	SKC-2-001-0074-0	SET GUIDE/LEFT	PCS	2
13	SKC-2-120-0009-0	SHELF	PCS	2
14	SKC-2-001-0075-0	SET GUIDE/RIGHT	PCS	2
15	SKC-2-001-0001-0	FRONT SUPPORT/LEFT	PCS	2
16	SKC-2-001-0030-0	BACK SUPPORT/LEFT	PCS	2
17	SKC-2-001-0002-0	FRONT SUPPORT/RIGHT	PCS	2
18	SKC-2-001-0032-0	BACK SUPPORT/RITH	PCS	2
19	SKC-2-003-6015-0	EVAPORATOR COVER	PCS	1
20	SKC-2-170-0050-0	TOP	SET	1
21	SKC-4-030-0006-0	SENSOR	PCS	1
22	SKC-2-002-0036-0	PROBE PADDING	PCS	2
23	SKC-2-110-0046-0	FAN SUPPORT	PCS	1
24	SKC-4-001-0006-0	EVAPORATOR FAN	PCS	1
25	SKC-2-101-0153-0	EVAPORATOR	PCS	1
26	SKC-2-003-0025-0	UNIT ROOM COVER	PCS	1
27	SKC-4-040-0081-0	COMPRESSOR	PCS	1
28	SKC-2-104-0217-0	hot pipe	PCS	1
29	SKC-4-001-0005-0	CONDENSOR FAN	PCS	1
30	SKC-2-105-0003-0	CONDENSOR FAN blade	PCS	1
31	SKC-2-120-0041-0	BASKET GUARD GRILLS	PCS	1
32	SKC-2-102-0048-0	CONDENSOR	PCS	1
33	SKC-2-103-0001-0	FILTER DRIER	PCS	1
34	SKC-2-104-0165-0	CAPILLARY	PCS	1
35	SKC-2-120-0050-0	FILTER	PCS	1
36	SKC-2-001-0131-0	UNIT BOARD	PCS	1
37	SKC-4-010-0080-0	power core	PCS	1
38	SKC-2-001-0107-0	DRAWER GUIDE/RIGHT	PCS	7
39	SKC-2-001-0496-0	FRONT PANEL UP HINGE	PCS	1
40	SKC-2-110-0010-0	water box protector	PCS	1
41	SKC-2-110-0021-0	clip	PCS	1
42	SKC-2-001-0497-0	FRONT PANEL DOWN HINGE	PCS	1
43	SKC-2-003-0929-0	FRONG PANEL	PCS	1
44	SKC-4-050-0001-0	MAIN SWITCH	PCS	1
45	SKC-4-030-0002-0	thermostat	PCS	1
46	SKC-2-170-0081-0	LOCK	PCS	1
47	SKC-2-140-0001-0	foot	PCS	6
48	SKC-0-000-0029-0	INNER WATER PAN	PCS	1

49	SKC-2-110-0492-0	OUTER WATER PAN	PCS	1
50	SKC-0-000-0503-0	PIZZA BODY	SET	1
51	SKC-0-000-0504-0	DRAWER	SET	7
52	SKC-2-001-0106-0	DRAWER GUIDE/LEFT	PCS	7
53				