

Induction Cooker Diagram-IDS7

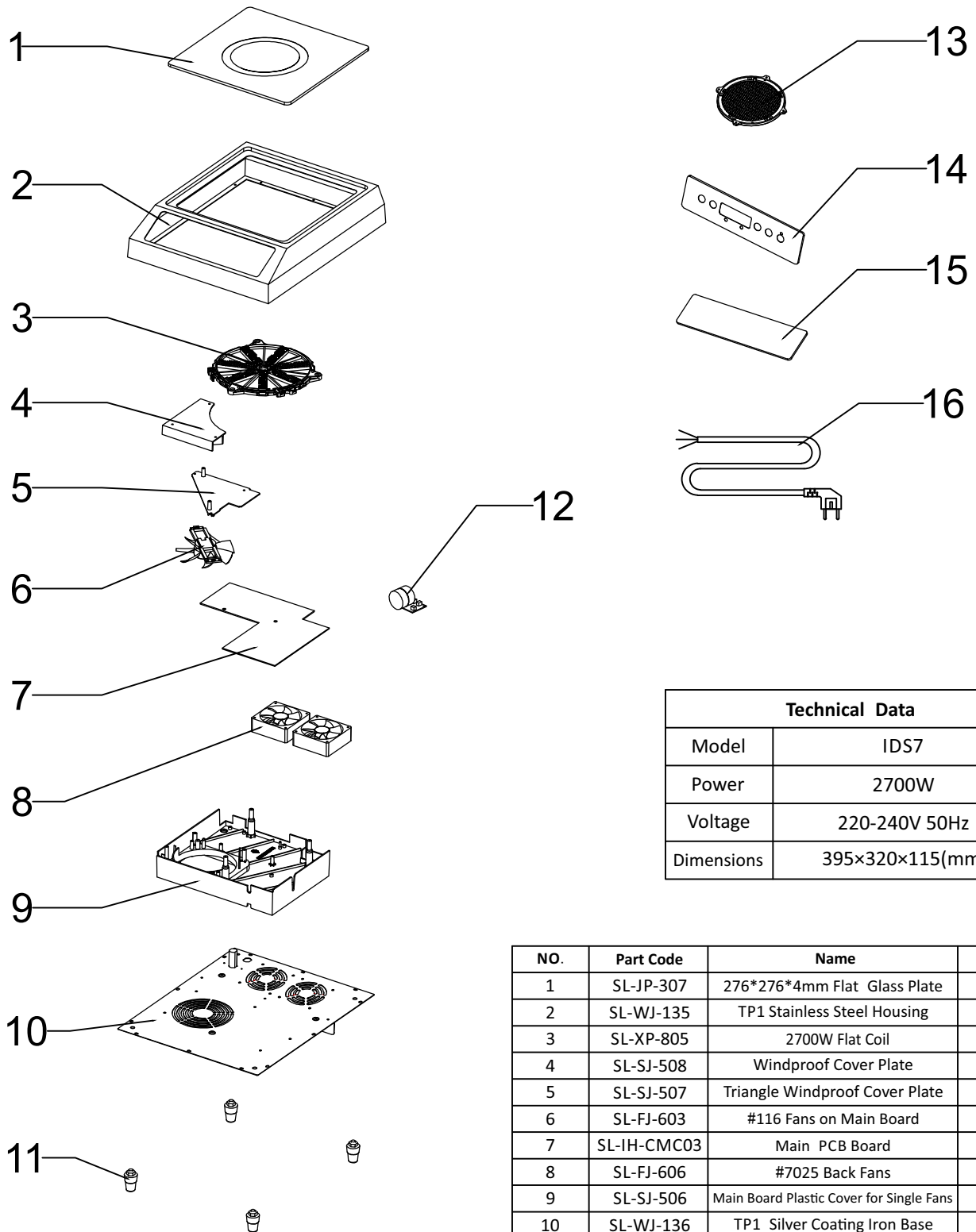

Technical Data	
Model	IDS7
Power	2700W
Voltage	220-240V 50Hz
Dimensions	395×320×115(mm)

NO.	Part Code	Name	Qty
1	SL-JP-307	276*276*4mm Flat Glass Plate	1
2	SL-WJ-135	TP1 Stainless Steel Housing	1
3	SL-XP-805	2700W Flat Coil	1
4	SL-SJ-508	Windproof Cover Plate	1
5	SL-SJ-507	Triangle Windproof Cover Plate	1
6	SL-FJ-603	#116 Fans on Main Board	1
7	SL-IH-CMC03	Main PCB Board	1
8	SL-FJ-606	#7025 Back Fans	2
9	SL-SJ-506	Main Board Plastic Cover for Single Fans	1
10	SL-WJ-136	TP1 Silver Coating Iron Base	1
11	SL-JJ-205	#33 Silicone Feet	4
12	SL-IH-EMC01	Filter	1
13	SL-WJ-122	Round Air Filter	1
14	SL-IH-NJ31GS	PCB Control Board	1
15	SL-BL-410	Glass Control Panel	1
16	SL-DY-903	3*1.5mm Power Line	1