

NEUTRAL SERVICE UNITS

CONTENTS

A	GENERAL INFORMATION.....	Page 2
A1	PRODUCT DESCRIPTION.....	Page 3
A2	TECHNICAL INFORMATION	Page 3
A3	TRANSPORTATION	Page 4
A4	UNPACKING	Page 4
B	INSTALLATION.....	Page 4
C	SAFETY INSTRUCTIONS	Page 5
D	OPERATION.....	Page 6
E	CLEANING & MAINTENANCE	Page 7
F	TROUBLESHOOTING	Page 8
G	SPARE PART LIST- EXPLODING DRAWING	Page 9
H	ELECTRIC CIRCUIT SCHEMA	Page 15

A GENERAL INFORMATION

Before installing the appliance, read operation and maintenance instructions carefully. Wrong installation and part changing may damage the product or may cause injury on people. These are not in our company's responsibility to damage the appliance intentionally, negligence, detriments because of disobeying instructions and regulations, wrong connections. Unauthorized intervention to appliance invalidates the warranty.

1. This instruction manual should be kept in a safe place for future reference.
2. **Installation should be made in accordance with ordinances and security rules of that country by a qualified service personnel.**
3. This appliance has to be used by trained person.
4. Please turn off the appliance immediately in the event of malfunction or failure. The appliance should be repaired only by authorized service personnel. Please demand original spare part.

NEUTRAL SERVICE UNITS

A1 PRODUCT DESCRIPTION

*The Professional Neutral Service Units ,that provides high efficiency has been designed to be used in industrial kitchen.

Product Code	Dimensions (mm)	Weight (kg)	Packaging Dimensions (mm)
EMP.NS.10	600x790x850	66	720x950x1550
EMP.NS.30	900x790x850	70	1020x950x1550
EMP.NS.50	1150x790x850	85	1370x950x1550
EMP.NS.70	1500x790x850	95	1620x950x1550
EMP.NS.90	1800x790x850	105	2120x950x1550

A2 TECHNICAL INFORMATION

Product Code	Power (KW)	Operating Voltage (V)	Cable (mm ²)	Accessories
EMP.NS.10	200	220	3x1,5	*Wooden decor *Top shelf group *Tray sliding stand *Convex glass *Granite stand
EMP.NS.30	200	220	3x1,5	
EMP.NS.50	200	220	3x1,5	
EMP.NS.70	200	220	3x1,5	
EMP.NS.90	200	220	3x1,5	

A3 TRANSPORTATION

*This appliance can not be moved by hand from area to area. It must be moved on pallet with forklift truck.

A4 UNPACKING

*Please unpack the package according to the security codes and ordinances of current country and get rid from the pack. Parts which contacts with food are produced by stainless steel. All plastic parts are marked by material's symbol.

*Please check that all the parts of appliance had come completely and if they are damaged or not during the shipping.

B INSTALLATION

*Please place the product to straight and sturdy ground, please take necessary steps against possibility of overturn.

*Technician who will serve for installation and service for the appliance must be professional on this subject and must have installation and service licenses by the company.

*Connection to Electric Power Supply must be done by authorized person.

*Please be sure that the voltage connected to appliance must be equal with the voltage which is on appliance's label.











This appliance must be connected to an earthed outlet in accordance with safety rules and standard.

*Appliance's earthing must be connected to earthing line on panel which is nearest to electric installation.

*Connection to the main fuse and leak current fuse must be done in accordance with the current regulations.

NEUTRAL SERVICE UNITS

C SAFETY INSTRUCTIONS

-  *Do not use the appliance in insufficient lighted place.
-  *Do not touch the moving attachments while the appliance operates.
-  *Do not install the appliance in the presence of flammable or explosive materials.
-  *Do not operate the appliance when the machine is empty.
-  *Do not load so less or more than appliance's capacity.
-  *Do not attempt to use the appliance without suitable protective equipments.
-  *Because of any reason if there is a fire or flame flare where the appliance is used, turn off all gas valves and electric contactor switch quickly and use fire extinguisher. Never use water to extinguish the fire.
-  *All the damages because of not having earthing connection will not be on warranty.
-  *Do not place heavy objects on to the appliance.

NEUTRAL SERVICE UNITS

D OPERATION

*Control Panel;

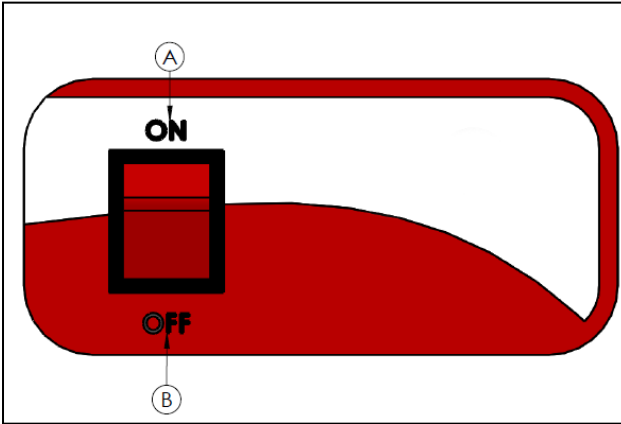

A : Top lighting ON position
B : Top lighting OFF position

*Operating;

- Clean the outer surface and upper stand and dry before first use.
- Plug in the appliance for top lighting system.
- Place the foods that have been prepared cold or hot on to the upper stand and service.
- After the operation is completed,unplug the appliance.

NEUTRAL SERVICE UNITS

E CLEANING & MAINTENANCE

➤ **CLEANING AND MAINTENANCE AFTER EVERY USE**

- Always turn off the appliance and disconnect from the power supply before cleaning.
- Clean the outer surface of the appliance with moist cloth.
- Clean the inside of the appliance with moist soapy cloth. Then clean with wet cloth and dry.
- Pay attention the cleaning materials to be hygienic.
- Do not use abrasive cleaning chemicals as these can leave harmful residues.
- Do not clean the appliance by spraying water directly ,Otherwise electric motor may get damaged.

➤ **PERIODIC CLEANING AND MAINTENANCE**

- Maintenance should be done by qualified person.
- Clean the top shelf glass group with moist cloth according to frequency of use.
- Clean the top lighting lamp with dry cloth in periodic times.

F TROUBLESHOOTING

THE LIGHTING LAMP DOESN'T OPERATE	<ol style="list-style-type: none">1. Check if the appliance is plugged in.2. Check the electrical connections and voltage.3. If the lamp is broken,change it.
--	---

- | |
|---|
| <ul style="list-style-type: none">• If the materials are not kept at suitable quality• If any function of security doesn't work<ul style="list-style-type: none">➤ Do not use the appliance. |
|---|

***If these problems are still going on,contact with our authorized services.**

NEUTRAL SERVICE UNITS

G SPARE PART LIST- EXPLODING DRAWINGS

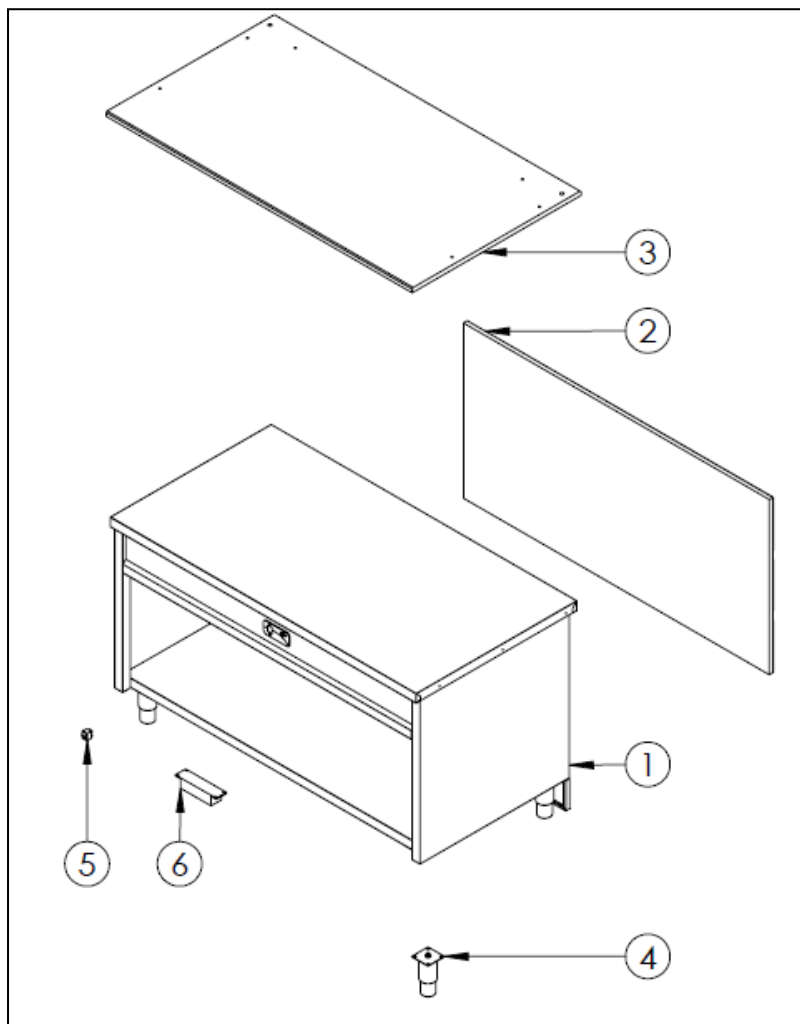

EMP.NS.10 - 30 - 50 - 70 - 90

NEUTRAL SERVICE UNITS

G SPARE PART LIST- EXPLODING DRAWINGS

PRODUCT CODE : EMP.NS.10		
NUMBER	PRODUCT NAME	PRODUCT CODE
1	BASE FRAME	Y.EMP.NS.10.1001
2	PARTICLE BOARD	Y.EMP.NS.10.1002
3	GRANITE	Y.EMP.NS.10.1003
4	FEET	Y.EMP.NS.10.1004
5	SWITCH	Y.EMP.NS.10.1005
6	LED MOTOR	Y.EMP.NS.10.1006
PRODUCT CODE : EMP.NS.30		
NUMBER	PRODUCT NAME	PRODUCT CODE
1	BASE FRAME	Y.EMP.NS.30.1001
2	PARTICLE BOARD	Y.EMP.NS.30.1002
3	GRANITE	Y.EMP.NS.30.1003
4	FEET	Y.EMP.NS.30.1004
5	SWITCH	Y.EMP.NS.30.1005
6	LED MOTOR	Y.EMP.NS.30.1006
PRODUCT CODE : EMP.NS.50		
NUMBER	PRODUCT NAME	PRODUCT CODE
1	BASE FRAME	Y.EMP.NS.50.1001
2	PARTICLE BOARD	Y.EMP.NS.50.1002
3	GRANITE	Y.EMP.NS.50.1003
4	FEET	Y.EMP.NS.50.1004
5	SWITCH	Y.EMP.NS.50.1005
6	LED MOTOR	Y.EMP.NS.50.1006
PRODUCT CODE :EMP.NS.70		
NUMBER	PRODUCT NAME	PRODUCT CODE
1	BASE FRAME	Y.EMP.NS.70.1001
2	PARTICLE BOARD	Y.EMP.NS.70.1002
3	GRANITE	Y.EMP.NS.70.1003
4	FEET	Y.EMP.NS.70.1004
5	SWITCH	Y.EMP.NS.70.1005
6	LED MOTOR	Y.EMP.NS.70.1006
PRODUCT CODE : EMP.NS.90		
NUMBER	PRODUCT NAME	PRODUCT CODE
1	BASE FRAME	Y.EMP.NS.90.1001
2	PARTICLE BOARD	Y.EMP.NS.90.1002
3	GRANITE	Y.EMP.NS.90.1003
4	FEET	Y.EMP.NS.90.1004
5	SWITCH	Y.EMP.NS.90.1005
6	LED MOTOR	Y.EMP.NS.90.1006

NEUTRAL SERVICE UNITS

G SPARE PART LIST- EXPLODING DRAWINGS

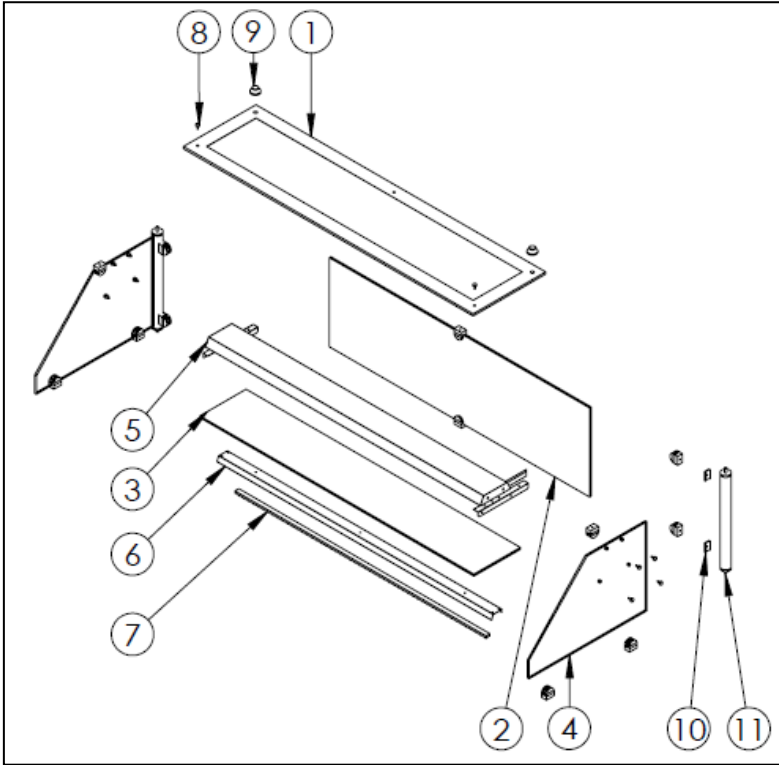

TOP GLASS GROUP

NEUTRAL SERVICE UNITS

G SPARE PART LIST- EXPLODING DRAWINGS

PRODUCT CODE EMP.NS.10.USC.T

NUMBER	PRODUCT NAME	PRODUCT CODE
1	TOP GLASS	Y.EMP.NS.10.USC.T.1001
2	FRONT GLASS	Y.EMP.NS.10.USC.T.1002
3	GLASS SHELF	Y.EMP.NS.10.USC.T.1003
4	SIDE GLASS	Y.EMP.NS.10.USC.T.1004
5	TOP LAMP HOLDER	Y.EMP.NS.10.USC.T.1005
6	SHELF LAMP HOLDER	Y.EMP.NS.10.USC.T.1006
7	LED	Y.EMP.NS.10.USC.T.1007
8	SCREW LID	Y.EMP.NS.10.USC.T.1008
9	PIPE LID	Y.EMP.NS.10.USC.T.1009
10	GLASS HOLDER	Y.EMP.NS.10.USC.T.1010
11	PIPE	Y.EMP.NS.10.USC.T.1011

PRODUCT CODE : EMP.NS.30.USC.T

NUMBER	PRODUCT NAME	PRODUCT CODE
1	TOP GLASS	Y.EMP.NS.30.USC.T.1001
2	FRONT GLASS	Y.EMP.NS.30.USC.T.1002
3	GLASS SHELF	Y.EMP.NS.30.USC.T.1003
4	SIDE GLASS	Y.EMP.NS.30.USC.T.1004
5	TOP LAMP HOLDER	Y.EMP.NS.30.USC.T.1005
6	SHELF LAMP HOLDER	Y.EMP.NS.30.USC.T.1006
7	LED	Y.EMP.NS.30.USC.T.1007
8	SCREW LID	Y.EMP.NS.30.USC.T.1008
9	PIPE LID	Y.EMP.NS.30.USC.T.1009
10	GLASS HOLDER	Y.EMP.NS.30.USC.T.1010
11	PIPE	Y.EMP.NS.30.USC.T.1011

PRODUCT CODE : EMP.NS.50.USC.T

NUMBER	PRODUCT NAME	PRODUCT CODE
1	TOP GLASS	Y.EMP.NS.50.USC.T.1001
2	FRONT GLASS	Y.EMP.NS.50.USC.T.1002
3	GLASS SHELF	Y.EMP.NS.50.USC.T.1003
4	SIDE GLASS	Y.EMP.NS.50.USC.T.1004
5	TOP LAMP HOLDER	Y.EMP.NS.50.USC.T.1005
6	SHELF LAMP HOLDER	Y.EMP.NS.50.USC.T.1006
7	LED	Y.EMP.NS.50.USC.T.1007
8	SCREW LID	Y.EMP.NS.50.USC.T.1008
9	PIPE LID	Y.EMP.NS.50.USC.T.1009
10	GLASS HOLDER	Y.EMP.NS.50.USC.T.1010
11	PIPE	Y.EMP.NS.50.USC.T.1011

PRODUCT CODE : EMP.NS.70.USC.T

NUMBER	PRODUCT NAME	PRODUCT CODE
1	TOP GLASS	Y.EMP.NS.70.USC.T.1001
2	FRONT GLASS	Y.EMP.NS.70.USC.T.1002
3	GLASS SHELF	Y.EMP.NS.70.USC.T.1003
4	SIDE GLASS	Y.EMP.NS.70.USC.T.1004
5	TOP LAMP HOLDER	Y.EMP.NS.70.USC.T.1005
6	SHELF LAMP HOLDER	Y.EMP.NS.70.USC.T.1006
7	LED	Y.EMP.NS.70.USC.T.1007
8	SCREW LID	Y.EMP.NS.70.USC.T.1008
9	PIPE LID	Y.EMP.NS.70.USC.T.1009
10	GLASS HOLDER	Y.EMP.NS.70.USC.T.1010
11	PIPE	Y.EMP.NS.70.USC.T.1011

PRODUCT CODE : EMP.NS.90.USC.T

NUMBER	PRODUCT NAME	PRODUCT CODE
1	TOP GLASS	Y.EMP.NS.90.USC.T.1001
2	FRONT GLASS	Y.EMP.NS.90.USC.T.1002
3	GLASS SHELF	Y.EMP.NS.90.USC.T.1003
4	SIDE GLASS	Y.EMP.NS.90.USC.T.1004
5	TOP LAMP HOLDER	Y.EMP.NS.90.USC.T.1005
6	SHELF LAMP HOLDER	Y.EMP.NS.90.USC.T.1006
7	LED	Y.EMP.NS.90.USC.T.1007
8	SCREW LID	Y.EMP.NS.90.USC.T.1008
9	PIPE LID	Y.EMP.NS.90.USC.T.1009
10	GLASS HOLDER	Y.EMP.NS.90.USC.T.1010
11	PIPE	Y.EMP.NS.90.USC.T.1011

NEUTRAL SERVICE UNITS

G SPARE PART LIST- EXPLODING DRAWINGS

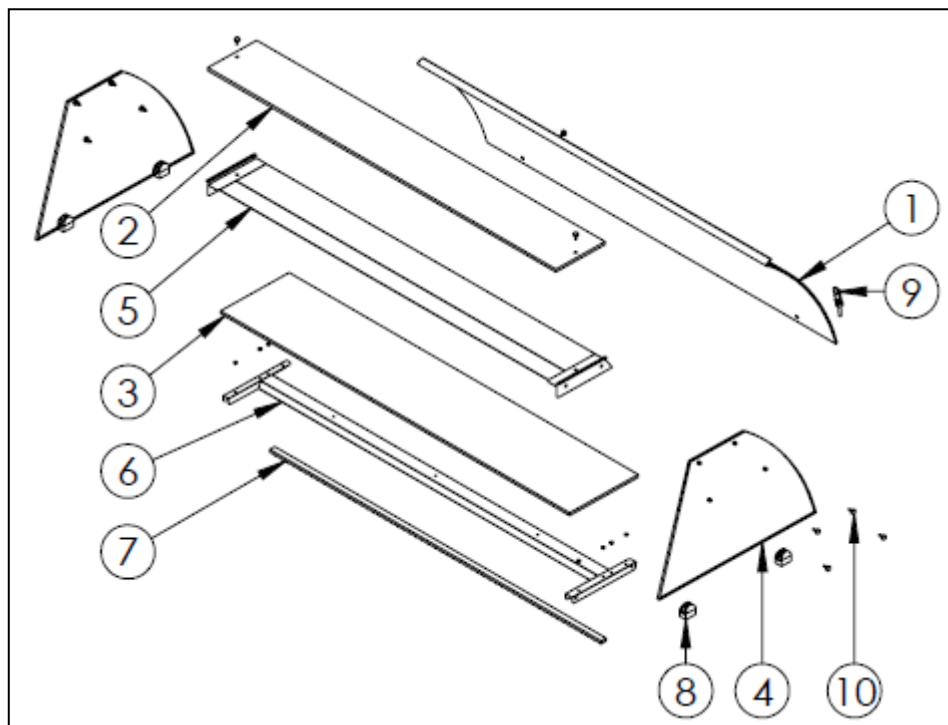

CONVEX GLASS GROUP

NEUTRAL SERVICE UNITS

G SPARE PART LIST- EXPLODING DRAWINGS

PRODUCT CODE : EMP.NS.10.BC.T

NUMBER	PRODUCT NAME	PRODUCT CODE
1	FRONT GLASS	Y.EMP.NS.10.BC.T.1001
2	TOP GLASS	Y.EMP.NS.10.BC.T.1002
3	GLASS SHELF	Y.EMP.NS.10.BC.T.1003
4	SIDE GLASS	Y.EMP.NS.10.BC.T.1004
5	TOP LAMP HOLDER	Y.EMP.NS.10.BC.T.1005
6	SHELF LAMP HOLDER	Y.EMP.NS.10.BC.T.1006
7	LED	Y.EMP.NS.10.BC.T.1007
8	HOLDER	Y.EMP.NS.10.BC.T.1008
9	HINGE	Y.EMP.NS.10.BC.T.1009
10	SCREW LID	Y.EMP.NS.10.BC.T.1010

PRODUCT CODE : EMP.NS.30.BC.T

NUMBER	PRODUCT NAME	PRODUCT CODE
1	FRONT GLASS	Y.EMP.NS.30.BC.T.1001
2	TOP GLASS	Y.EMP.NS.30.BC.T.1002
3	GLASS SHELF	Y.EMP.NS.30.BC.T.1003
4	SIDE GLASS	Y.EMP.NS.30.BC.T.1004
5	TOP LAMP HOLDER	Y.EMP.NS.30.BC.T.1005
6	SHELF LAMP HOLDER	Y.EMP.NS.30.BC.T.1006
7	LED	Y.EMP.NS.30.BC.T.1007
8	HOLDER	Y.EMP.NS.30.BC.T.1008
9	HINGE	Y.EMP.NS.30.BC.T.1009
10	SCREW LID	Y.EMP.NS.30.BC.T.1010

PRODUCT CODE : EMP.NS.50.BC.T

NUMBER	PRODUCT NAME	PRODUCT CODE
1	FRONT GLASS	Y.EMP.NS.50.BC.T.1001
2	TOP GLASS	Y.EMP.NS.50.BC.T.1002
3	GLASS SHELF	Y.EMP.NS.50.BC.T.1003
4	SIDE GLASS	Y.EMP.NS.50.BC.T.1004
5	TOP LAMP HOLDER	Y.EMP.NS.50.BC.T.1005
6	SHELF LAMP HOLDER	Y.EMP.NS.50.BC.T.1006
7	LED	Y.EMP.NS.50.BC.T.1007
8	HOLDER	Y.EMP.NS.50.BC.T.1008
9	HINGE	Y.EMP.NS.50.BC.T.1009
10	SCREW LID	Y.EMP.NS.50.BC.T.1010

PRODUCT CODE : EMP.NS.70.BC.T

NUMBER	PRODUCT NAME	PRODUCT CODE
1	FRONT GLASS	Y.EMP.NS.70.BC.T.1001
2	TOP GLASS	Y.EMP.NS.70.BC.T.1002
3	GLASS SHELF	Y.EMP.NS.70.BC.T.1003
4	SIDE GLASS	Y.EMP.NS.70.BC.T.1004
5	TOP LAMP HOLDER	Y.EMP.NS.70.BC.T.1005
6	SHELF LAMP HOLDER	Y.EMP.NS.70.BC.T.1006
7	LED	Y.EMP.NS.70.BC.T.1007
8	HOLDER	Y.EMP.NS.70.BC.T.1008
9	HINGE	Y.EMP.NS.70.BC.T.1009
10	SCREW LID	Y.EMP.NS.70.BC.T.1010

PRODUCT CODE : EMP.NS.90.BC.T

NUMBER	PRODUCT NAME	PRODUCT CODE
1	FRONT GLASS	Y.EMP.NS.90.BC.T.1001
2	TOP GLASS	Y.EMP.NS.90.BC.T.1002
3	GLASS SHELF	Y.EMP.NS.90.BC.T.1003
4	SIDE GLASS	Y.EMP.NS.90.BC.T.1004
5	TOP LAMP HOLDER	Y.EMP.NS.90.BC.T.1005
6	SHELF LAMP HOLDER	Y.EMP.NS.90.BC.T.1006
7	LED	Y.EMP.NS.90.BC.T.1007
8	HOLDER	Y.EMP.NS.90.BC.T.1008
9	HINGE	Y.EMP.NS.90.BC.T.1009
10	SCREW LID	Y.EMP.NS.90.BC.T.1010

NEUTRAL SERVICE UNITS

H ELECTRIC CIRCUIT SCHEMA

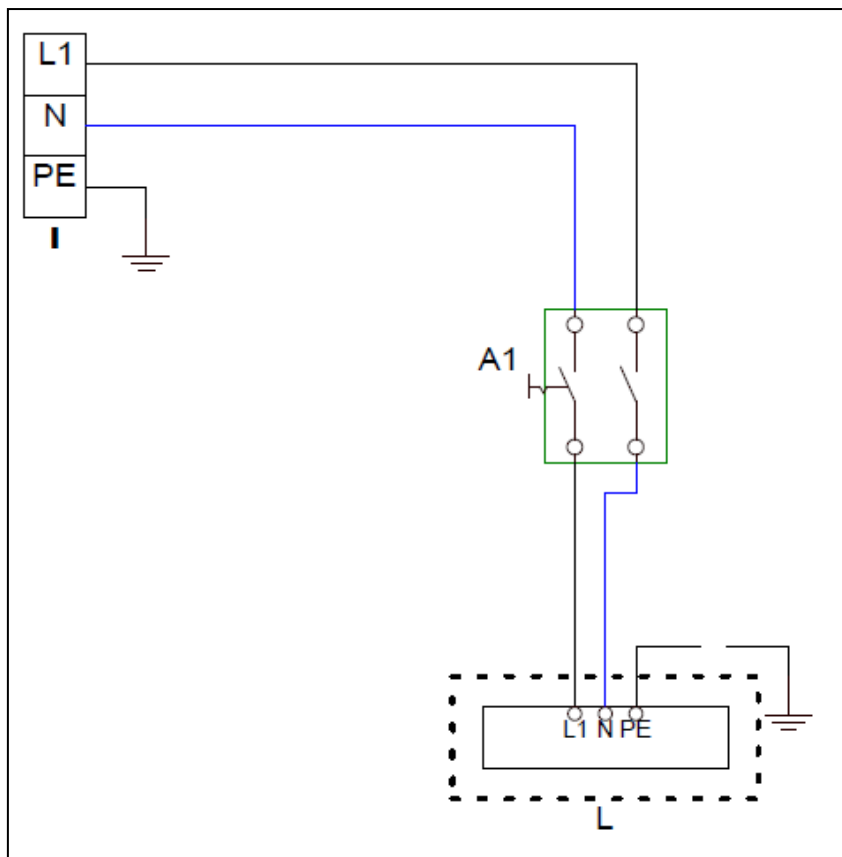

I	A1	L
Terminal	Large lighted 0-1 lighting switch	Lighting lamp