

Exploded Drawing of Bain Marie

| Code | Parts Name |
|------|------------------------|
| 1 | Nut for water pipe |
| 2 | water tank |
| 3 | Aluminium pipe |
| 4 | gasket for pipe |
| 5 | Silicon gasket for tap |
| 6 | Nut for tap |
| 7 | Frame |
| 54 | |
| 8 | tap |
| 9 | turning of thermostat |
| 10 | heating element |
| 11 | fasten for heater |
| 12 | nut for fasten |
| 13 | screw for fasten |
| 14 | EGO thermostat |
| 15 | Nut M4 |
| 16 | Switch |
| 17 | screw M4*8 |
| 18 | turning of thermostat |
| 19 | indicator light |
| 20 | Bolt M4*9 |
| 21 | Nut M4 |
| 22 | Bolt M4*9 |
| 23 | Nut M4 |
| 24 | screw M4*20 |
| 25 | earthing Al plate |
| 26 | Nut M4 |
| 27 | Gasket $\phi 4$ |
| 28 | Spring gasket $\phi 4$ |
| 29 | Nut M4 |
| 30 | Nut M4 |
| 31 | Ceramics terminal |
| 32 | screw M5.5*13 |
| 33 | leg |
| 34 | screw M5*16 |
| 35 | thermo reset |
| 36 | Nut M5 |
| 37 | Nut M6 |
| 38 | Bolt M3*20 |

| Code | Parts Name |
|------|----------------------|
| 39 | bottom |
| 40 | AL screw 3.2*11 |
| 41 | screw M3.5*9.5 |
| 42 | cover of mushroom |
| 43 | mushroom lid |
| 44 | spring |
| 45 | reset pole |
| 46 | nut |
| 47 | stand for reset pole |
| 48 | Nut M4*9 |
| 49 | thermo on/off |
| 50 | tray for heater |
| 51 | ceramics terminal |
| 52 | Nut M3*12 |
| 53 | wire and plug |
| 55 | screw 3.2*11 |

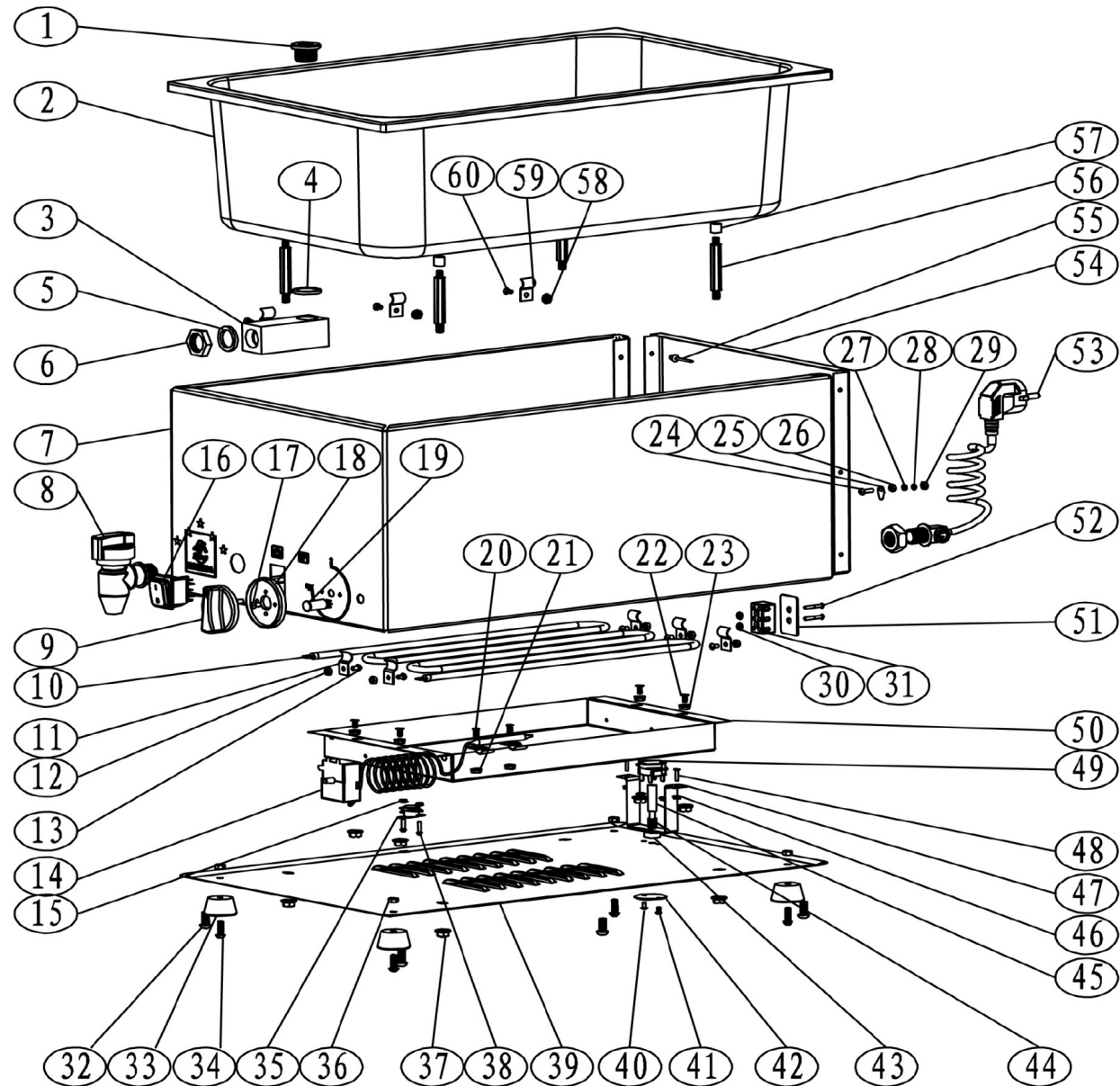

Note: please note that the red color parts just for Metro model, the current model without this design.