

MEAL DISTRIBUTION TROLLEY

CONTENTS

A	GENERAL INFORMATION	Page 2
A1	PRODUCT DESCRIPTION	Page 3
A2	TECHNICAL INFORMATION	Page 3
A3	TRANSPORTATION	Page 3
A4	UNPACKING	Page 3
B	INSTALLATION	Page 4
C	SAFETY INSTRUCTIONS	Page 5
D	OPERATION	Page 6
E	CLEANING & MAINTENANCE	Page 14
F	TROUBLESHOOTING	Page 15
G	SPARE PART LIST- EXPLODING DRAWING	Page 16
H	ELECTRIC CIRCUIT SCHEMA	Page 20

A GENERAL INFORMATION

Before installing the appliance, read operation and maintenance instructions carefully. Wrong installation and part changing may damage the product or may cause injury on people. These are not in our company's responsibility to damage the appliance intentionally, negligence, detriments because of disobeying instructions and regulations, wrong connections. Unauthorized intervention to appliance invalidates the warranty.

1. This instruction manual should be kept in a safe place for future reference.
- 2. Installation should be made in accordance with ordinances and security rules of that country by a qualified service personnel.**
3. This appliance has to be used by trained person.
4. Please turn off the appliance immediately in the event of malfunction or failure. The appliance should be repaired only by authorized service personnel. Please demand original spare part.

MEAL DISTRIBUTION TROLLEY

A1 PRODUCT DESCRIPTION

*The Professional Banquet Trolley, that provides high efficiency has been designed to be used in industrial kitchens.

Product Code	Dimensions (mm)	Weight (kg)	Packaging Dimensions (mm)
MED.S.24-1/2	811x1148x1436	203	860x1200x1470
BWHKSE3763	811x1148x1436	203	860x1200x1470

A2 TECHNICAL INFORMATION

Product Code	MED.S.24-1/2	BWHKSE3763
Capacity	24 tray	24 tray
Power (Kw)	5,8	5,8
Operating Voltage (V)	220 – 230 380-400	220 – 230 380-400
Cable (mm ²)	3x2,5	3x2,5
Cold Compartment (°C)	-4 / +8	-4 / +8
Hot Compartment (°C)	40 / 130	40 / 130
Type of Gas	R-134A	R-134A
Gaz Wight (Gr)	600	600
Protection Level	IP-65	IP-65

A3 TRANSPORTATION

*This appliance can not be moved by hand from area to area. It must be moved on pallet with forklift truck.

A4 UNPACKING

*Please unpack the package according to the security codes and ordinances of current country and get rid from the pack. Parts which contacts with food are produced by stainless steel. All plastic parts are marked by material's symbol.

*Please check that all the parts of appliance had come completely and if they are damaged or not during the shipping.

MEAL DISTRIBUTION TROLLEY

B **INSTALLATION**

*Please place the product to straight and sturdy ground, please take necessary steps against possibility of overturn.

*Technician who will serve for installation and service for the appliance must be professional on this subject and must have installation and service licenses by the company.

*Connection to Electric Power Supply must be done by authorized person.

*Please be sure that the voltage connected to appliance must be equal with the voltage which is on appliance's label.













This appliance must be connected to an earthed outlet in accordance with safety rules and standards.

*Appliance's earthing must be connected to earthing line on panel which is nearest to electric installation.

*Connection to the main fuse and leak current fuse must be done in accordance with the current regulations.

MEAL DISTRIBUTION TROLLEY

C SAFETY INSTRUCTIONS

-  *Do not use the appliance in insufficient lighted place.
-  *Do not touch the moving attachments while the appliance operates.
-  *Do not install the appliance in the presence of flammable or explosive materials.
-  *Do not operate the appliance when the machine is empty.
-  *Do not load so less or more than appliance's capacity.
-  *Do not attempt to use the appliance without suitable protective equipments.
-  *Because of any reason if there is a fire or flame flare where the appliance is used, turn off all gas valves and electric contactor switch quickly and use fire extinguisher. Never use water to extinguish the fire.
-  *All the damages because of not having earthing connection will not be on warranty.
-  *Get the necessary cautions against electric danger.
-  *Do not leave the door open while moving the banquet trolley. It may be dangerous to move the door without control. Unplug and leave the plug on the trolley..

MEAL DISTRIBUTION TROLLEY

D OPERATION

MAIN PAGE :

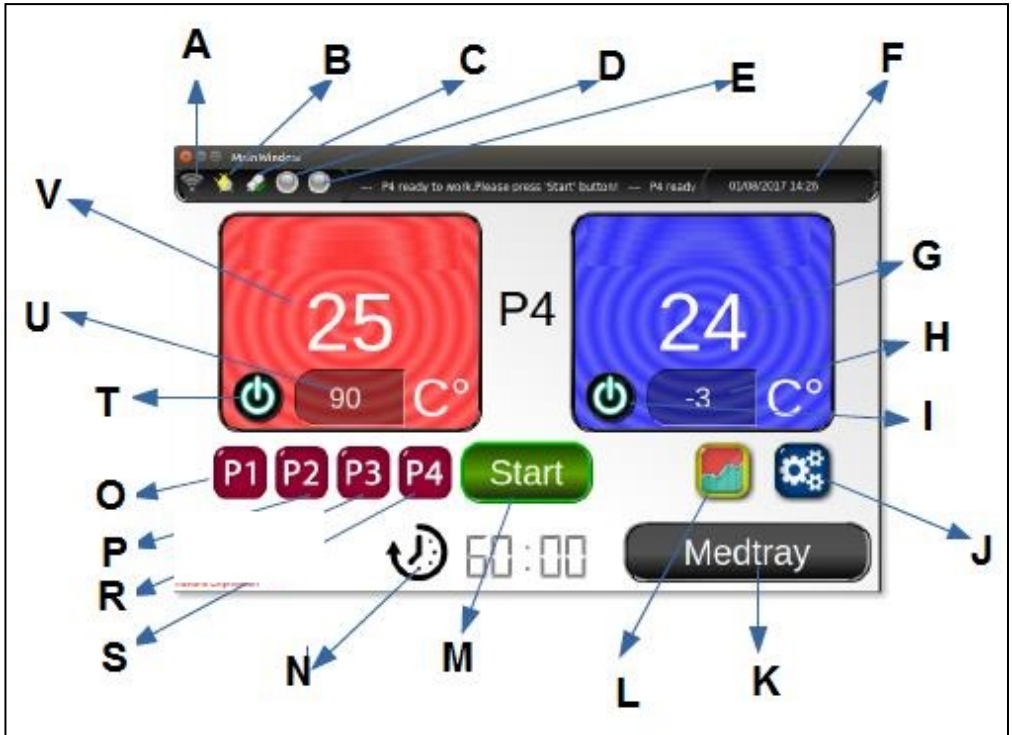

MEAL DISTRIBUTION TROLLEY

- A** : Shows the connection status with the server
- B**: Shows the power status. The battery icon appears when the plug is removed
- C**: Shows the communication status
- D**: If the hot section is working, it lights up
- E**: If the cold section is working, it lights up
- F**: Displays current date / time
- G**: Shows the temperature of the cold zone
- H**: Shows the set temperature of cold section
- I**: Switch off cold section
- J**: Go to settings page
- K**: Shows distribution trolleys name
- L**: Switches to the graphics screen
- M**: Start / stop the distribution trolley
- N**: Shows the remaining time
- O**: Starts program 1
- P**: Starts program 2
- R**: Starts program 3
- Q**: Starts program 4
- T**: Closes hot section
- U**: Shows the set temperature of the hot zone
- V**: Shows the temperature of the hot zone

MEAL DISTRIBUTION TROLLEY

GRAPHIC SCREEN AND USAGE:

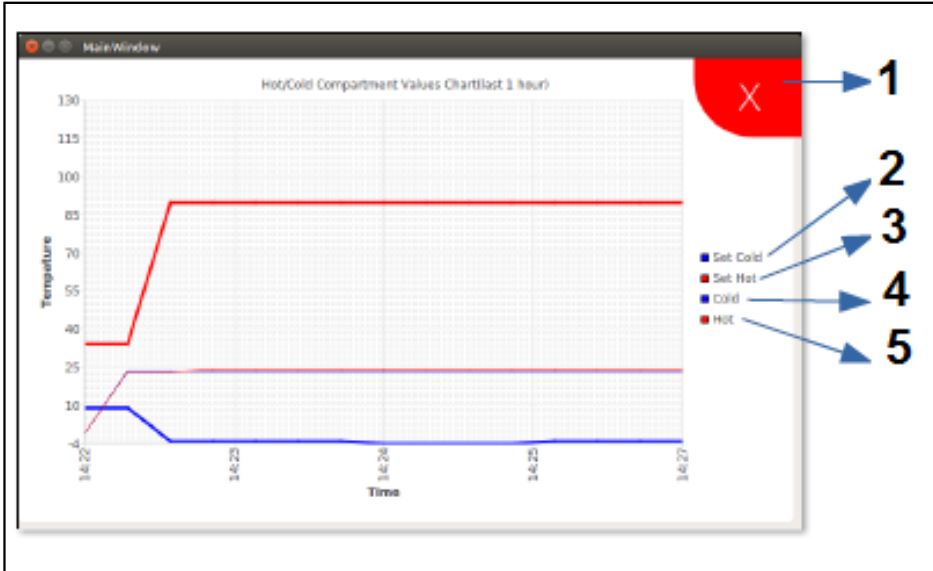

- 1 :Turn off graphic screen.
- 2: The thick blue line shows the set cold value.
- 3: The thick red line shows the set hot value.
- 4: The thin blue line shows the measured cold value.
- 5: The thin red line shows the measured hot value

MEAL DISTRIBUTION TROLLEY

ENTRY TO THE SETTINGS PAGE AND USAGE:



1 : You must write your password here to enter the settings page. If you didn't change, the default password is "1234".

2: Touch this button to log in.

3: Touch this button to enter settings.

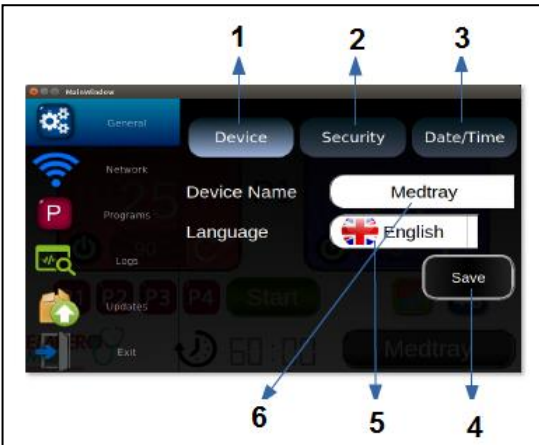

1 : General settings for the cart are found here.

2: Password related operations are found here.

3: Set the date and time is made on this page.

4: This page is used to save the settings which is made. Changes will not be saved if this button is not pressed.

5: This button is used to change the language.

6: The name of your cart is entered here. The main screen is displayed in the lower right corner.

MEAL DISTRIBUTION TROLLEY

CHANGE PASSWORD:



- 1: Enter your current password
- 2: Enter your new password
- 3: Re-enter your new password
- 4: Touch to saving

DATE / HOUR CHANGE:



- 1: Touch the icon to change the date
- 2: Touch the icon to change the time
- 3: Touch to save

MEAL DISTRIBUTION TROLLEY

NETWORK SETTINGS:

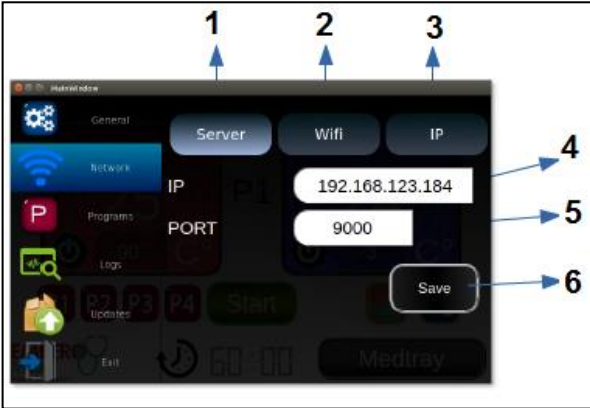

- 1: Server settings
- 2: Wi-Fi settings
- 3: IP settings
- 4: Server IP address
- 5: Server Port number
- 6: Save

WI - FI SETTINGS:



MEAL DISTRIBUTION TROLLEY

PROGRAM SETTINGS:

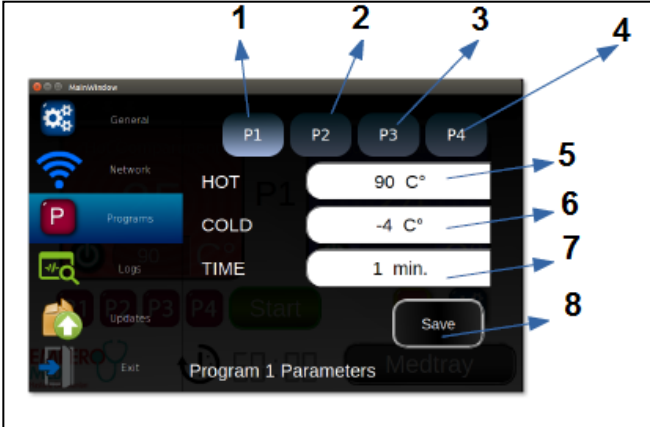

- 1: Program 1 parameters
- 2: Program 2 parameters
- 3: Program 3 parameters
- 4: Program 4 parameters
- 5: Set the hot value of the selected program
- 6: Adjust the cold value of the selected program
- 7: Set the time of the selected program
- 8: Save changes

RECORD THE LOG TO USB MEMORY



- 1 : Registration start date
- 2: Registration end date
- 3: This section displays the temperatures in the date range.
- 4: This section sends the temperature shown on the screen to USB

MEAL DISTRIBUTION TROLLEY

UPDATE :



1: Touch here to scan the USB drive and find the update file.

2: Touch this button to load in case of an update.

3: Insert the USB flash drive in which the update file is stored into the USB port

MEAL DISTRIBUTION TROLLEY

E CLEANING & MAINTENANCE

➤ **CLEANING AND MAINTENANCE AFTER EVERY USE**

- Be sure that the trolley is cold (less than 40°C) before the cleaning.
- Always turn off the appliance and disconnect from the power supply before cleaning.
- Clean inside and outside of appliance with hot water and then dry.
- Do not use abrasive cleaning chemicals as these can leave harmful residues.
- Do not clean the appliance by spraying water directly, otherwise electric motor may get damaged.

➤ **PERIODIC CLEANING AND MAINTENANCE**

- Maintenance should be done by qualified person.
- Get the periodic maintenance of the appliance once in every 15 days.
- Check the wheels, electric connections, fan, control system, door and door lock once in every 6 months.

MEAL DISTRIBUTION TROLLEY

F TROUBLESHOOTING

THE APPLIANCE DOESN'T OPERATE	<ol style="list-style-type: none">1. Check if the appliance is plugged in.2. Check the electrical connections and voltage.
THE APPLIANCE DOESN'T HEAT	<ol style="list-style-type: none">1. Check the partition plastic. Contact with our authorized services.2. Fan may have error.In this situation inform the service.
THE APPLIANCE DOESN'T COOL	<ol style="list-style-type: none">1. Check the cooler motor. Contact with our authorized services.2. Fan may have error.In this situation inform the service.
THE APPLIANCE STOPPED	<ol style="list-style-type: none">1. The appliance can stop due to low voltage.In this situation check the voltage.
THE BRAKES CAN NOT BE APPLIED	<ol style="list-style-type: none">1. Brakes and Wheels may have error.In this situation inform the service.

- If heating- coling is not done at suitable quality
- If any function of security doesn't work
 - Do not use the appliance.

***If these problems are still going on,contact with our authorized services.**

MEAL DISTRIBUTION TROLLEY

G SPARE PART LIST-EXPLODING DRAWING

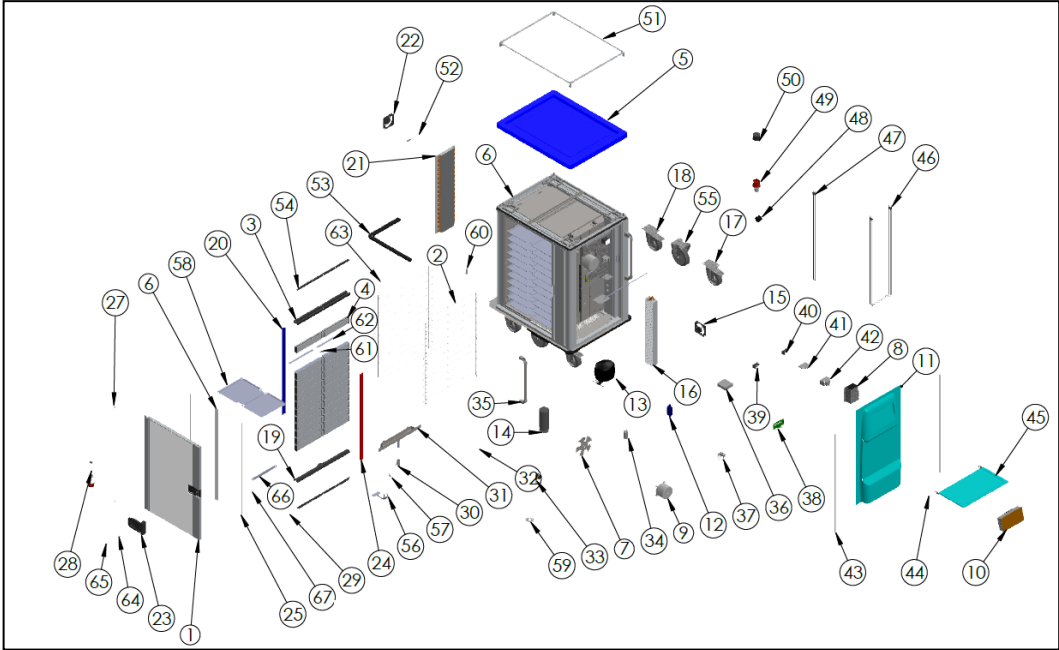

MED.S.24-1/2

MEAL DISTRIBUTION TROLLEY

G SPARE PART LIST-EXPLODING DRAWING

PRODUCT CODE: MED.S.24-1/2		
NO	PRODUCT NAME	PRODUCT CODE
1	COVER	Y.MED.S.24-1/2.001
2	WIRE SHELF	Y.MED.S.24-1/2.002
3	INTERMEDIATE COMPARTMENT PLASTIC	Y.MED.S.24-1/2.003
4	INTERMEDIATE COMPARTMENT ALUMINUM	Y.MED.S.24-1/2.004
5	TOP PLASTIC	Y.MED.S.24-1/2.005
6	CHASSIS	Y.MED.S.24-1/2.006
7	FAN WING	Y.MED.S.24-1/2.007
8	12V BATTERY	Y.MED.S.24-1/2.008
9	FAN MOTOR	Y.MED.S.24-1/2.009
10	PANEL + CARD SET	Y.MED.S.24-1/2.010
11	CONTROL PANEL PLASTIC	Y.MED.S.24-1/2.011
12	dryers yield	Y.MED.S.24-1/2.012
13	COOLER ENGINE	Y.MED.S.24-1/2.013
14	GAS STORAGE	Y.MED.S.24-1/2.014
15	CONDENSER FAN	Y.MED.S.24-1/2.015
16	CONDENSER	Y.MED.S.24-1/2.016
17	BRAKE WHEEL	Y.MED.S.24-1/2.017
18	FRENCH WHEEL	Y.MED.S.24-1/2.018
19	INTERMEDIATE COMPARTMENT PLASTIC	Y.MED.S.24-1/2.019
20	INTERMEDIATE COMPARTMENT ALUMINUM (BLUE)	Y.MED.S.24-1/2.020
21	EVAP	Y.MED.S.24-1/2.021
22	EVAP FAN	Y.MED.S.24-1/2.022
23	DOOR SIDE LOCK	Y.MED.S.24-1/2.023
24	INTERMEDIATE COMPARTMENT ALUMINUM (RED)	Y.MED.S.24-1/2.024
25	COVER SEAL (1mt)	Y.MED.S.24-1/2.025
26	COVER CENTRAL GASKET (1mt)	Y.MED.S.24-1/2.026
27	COVER HINGE SET	Y.MED.S.24-1/2.027
28	220 V. CONVERTER CABLE	Y.MED.S.24-1/2.028

MEAL DISTRIBUTION TROLLEY

29	INTERMEDIATE COMPARTMENT FIXING PIN	Y.MED.S.24-1/2.029
30	BALL VALVE	Y.MED.S.24-1/2.030
31	LEECH	Y.MED.S. 24-1/2.031
32	Termokulp	Y.MED.S. 24-1/2.032
33	GAS VALVE	Y.MED.S. 24-1/2.033
34	CAPACITOR	Y.MED.S. 24-1/2.034
35	HANDLE	Y.MED.S. 24-1/2.035
36	POWER SOURCE	Y.MED.S. 24-1/2.036
37	LIMIT THERMOSTAT	Y.MED.S. 24-1/2.037
38	SCREEN ROLE CARD	Y.MED.S. 24-1/2.038
39	CONDUCTOR DLEM-10	Y.MED.S. 24-1/2.039
40	CONDUCTOR DLEM-15-10	Y.MED.S. 24-1/2.040
41	FUSE 4 AMP	Y.MED.S. 24-1/2.041
42	INSURANCE 25 AMP	Y.MED.S.24-1/2.042
43	PANEL PLASTIC FIXING GASKET	Y.MED.S. 24-1/2.043
44	SHELF FIXING SCREW	Y.MED.S. 24-1/2.044
45	FOLDING SHELF	Y.MED.S. 24-1/2.045
46	U RESISTANCE	Y.MED.S. 24-1/2.046
47	BAR RESISTANCE	Y.MED.S. 24-1/2.047
48	CABLE HANDLE	Y.MED.S. 24-1/2.048
49	380 V. PLUG	Y.MED.S. 24-1/2.049
50	PLUG FIXING PLASTIC	Y.MED.S. 24-1/2.050
51	TOP PALSTIC ALUMINUM FRAME	Y.MED.S. 24-1/2.051
52	COOLING PROP	Y.MED.S. 24-1/2.052
53	BUFFER	Y.MED.S. 24-1/2.053
54	INTERMEDIATE COMPARTMENT SLIDES	Y.MED.S. 24-1/2.054
55	CENTER WHEEL	Y.MED.S. 24-1/2.055
56	WATER DISCHARGE PEDAL	Y.MED.S. 24-1/2.056
57	WATER DISCHARGE SPRING	Y.MED.S. 24-1/2.057
58	TRAY	Y.MED.S. 24-1/2.058
59	BALL VALVE FIXING SHEET	Y.MED.S. 24-1/2.059
60	REAR DOOR LOCKING APPARATUS (WITH BALL)	Y.MED.S. 24-1/2.060
61	INTERMEDIATE COMPARTMENT PLASTIC	Y.MED.S. 24-1/2.061
62	ALUMINUM INTERMEDIATE COMPARTMENT PLASTIC	Y.MED.S. 24-1/2.062
63	WIRE HANGER PIN	Y.MED.S. 241/2.063
64	DOOR LOCK BELL	Y.MED.S. 24-1/2.064
65	DOOR LOCK SWITCH	Y.MED.S. 24-1/2.065
66	INTERMEDIATE MICA PLASTIC	Y.MED.S. 24-1/2.066
67	INTERMEDIATE MICA SCREW	Y.MED.S. 24-1/2.067

MEAL DISTRIBUTION TROLLEY

G SPARE PART LIST-EXPLODING DRAWING

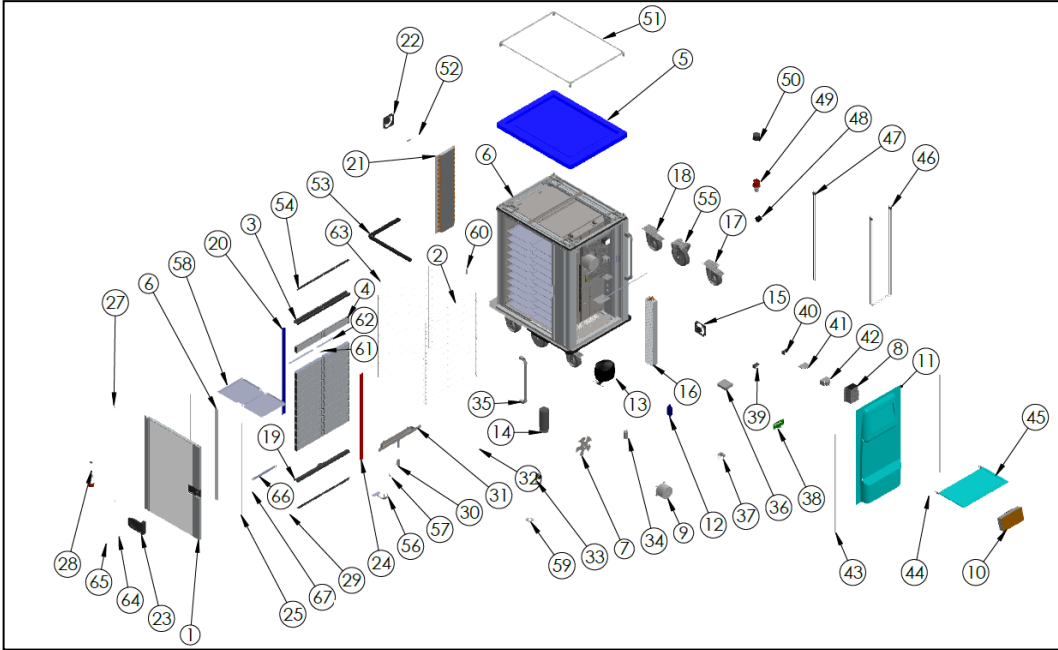

BWHKSE3763

MEAL DISTRIBUTION TROLLEY

G SPARE PART LIST-EXPLODING DRAWING

PRODUCT CODE: BWHKSE3763		
NO	PRODUCT NAME	PRODUCT CODE
1	COVER	Y.MED.S.24-1/3.001
2	WIRE SHELF	Y.MED.S.24-1/3.002
3	INTERMEDIATE COMPARTMENT PLASTIC	Y.MED.S.24-1/3.003
4	INTERMEDIATE COMPARTMENT ALUMINUM	Y.MED.S.24-1/3.004
5	TOP PLASTIC	Y.MED.S.24-1/3.005
6	CHASSIS	Y.MED.S.24-1/3.006
7	FAN WING	Y.MED.S.24-1/3.007
8	12V BATTERY	Y.MED.S.24-1/3.008
9	FAN MOTOR	Y.MED.S.24-1/3.009
10	PANEL + CARD SET	Y.MED.S.24-1/3.010
11	CONTROL PANEL PLASTIC	Y.MED.S.24-1/3.011
12	dryers yield	Y.MED.S.24-1/3.012
13	COOLER ENGINE	Y.MED.S.24-1/3.013
14	GAS STORAGE	Y.MED.S.24-1/3.014
15	CONDENSER FAN	Y.MED.S.24-1/3.015
16	CONDENSER	Y.MED.S.24-1/3.016
17	BRAKE WHEEL	Y.MED.S.24-1/3.017
18	FRENCH WHEEL	Y.MED.S.24-1/3.018
19	INTERMEDIATE COMPARTMENT PLASTIC	Y.MED.S.24-1/3.019
20	INTERMEDIATE COMPARTMENT ALUMINUM (BLUE)	Y.MED.S.24-1/3.020
21	EVAP	Y.MED.S.24-1/3.021
22	EVAP FAN	Y.MED.S.24-1/3.022
23	DOOR SIDE LOCK	Y.MED.S.24-1/3.023
24	INTERMEDIATE COMPARTMENT ALUMINUM (RED)	Y.MED.S.24-1/3.024
25	COVER SEAL (1mt)	Y.MED.S.24-1/3.025
26	COVER CENTRAL GASKET (1mt)	Y.MED.S.24-1/3.026
27	COVER HINGE SET	Y.MED.S.24-1/3.027
28	220 V. CONVERTER CABLE	Y.MED.S.24-1/3.028

MEAL DISTRIBUTION TROLLEY

29	INTERMEDIATE COMPARTMENT FIXING PIN	Y.MED.S.24-1/3.029
30	BALL VALVE	Y.MED.S.24-1/3.030
31	LEECH	Y.MED.S.24-1/3.031
32	Termokulp	Y.MED.S.24-1/3.032
33	GAS VALVE	Y.MED.S.24-1/3.033
34	CAPACITOR	Y.MED.S.24-1/3.034
35	HANDLE	Y.MED.S.24-1/3.035
36	POWER SOURCE	Y.MED.S.24-1/3.036
37	LIMIT THERMOSTAT	Y.MED.S.24-1/3.037
38	SCREEN ROLE CARD	Y.MED.S.24-1/3.038
39	CONDUCTOR DLEM-10	Y.MED.S.24-1/3.039
40	CONDUCTOR DLEM-15-10	Y.MED.S.24-1/3.040
41	FUSE 4 AMP	Y.MED.S.24-1/3.041
42	INSURANCE 25 AMP	Y.MED.S.24-1/3.042
43	PANEL PLASTIC FIXING GASKET	Y.MED.S.24-1/3.043
44	SHELF FIXING SCREW	Y.MED.S.24-1/3.044
45	FOLDING SHELF	Y.MED.S.24-1/3.045
46	U RESISTANCE	Y.MED.S.24-1/3.046
47	BAR RESISTANCE	Y.MED.S.24-1/3.047
48	CABLE HANDLE	Y.MED.S.24-1/3.048
49	380 V. PLUG	Y.MED.S.24-1/3.049
50	PLUG FIXING PLASTIC	Y.MED.S.24-1/3.050
51	TOP PALSTIC ALUMINUM FRAME	Y.MED.S.24-1/3.051
52	COOLING PROP	Y.MED.S.24-1/3.052
53	BUFFER	Y.MED.S.24-1/3.053
54	INTERMEDIATE COMPARTMENT SLIDES	Y.MED.S.24-1/3.054
55	CENTER WHEEL	Y.MED.S.24-1/3.055
56	WATER DISCHARGE PEDAL	Y.MED.S.24-1/3.056
57	WATER DISCHARGE SPRING	Y.MED.S.24-1/3.057
58	TRAY	Y.MED.S.24-1/3.058
59	BALL VALVE FIXING SHEET	Y.MED.S.24-1/3.059
60	REAR DOOR LOCKING APPARATUS (WITH BALL)	Y.MED.S.24-1/3.060
61	INTERMEDIATE COMPARTMENT PLASTIC	Y.MED.S.24-1/3.061
62	ALUMINUM INTERMEDIATE COMPARTMENT PLASTIC	Y.MED.S.24-1/3.062
63	WIRE HANGER PIN	Y.MED.S.24-1/3.063
64	DOOR LOCK BELL	Y.MED.S.24-1/3.064
65	DOOR LOCK SWITCH	Y.MED.S.24-1/3.065
66	INTERMEDIATE MICA PLASTIC	Y.MED.S.24-1/3.066
67	INTERMEDIATE MICA SCREW	Y.MED.S.24-1/3.067

MEAL DISTRIBUTION TROLLEY

H ELECTRIC CIRCUIT SCHEMA

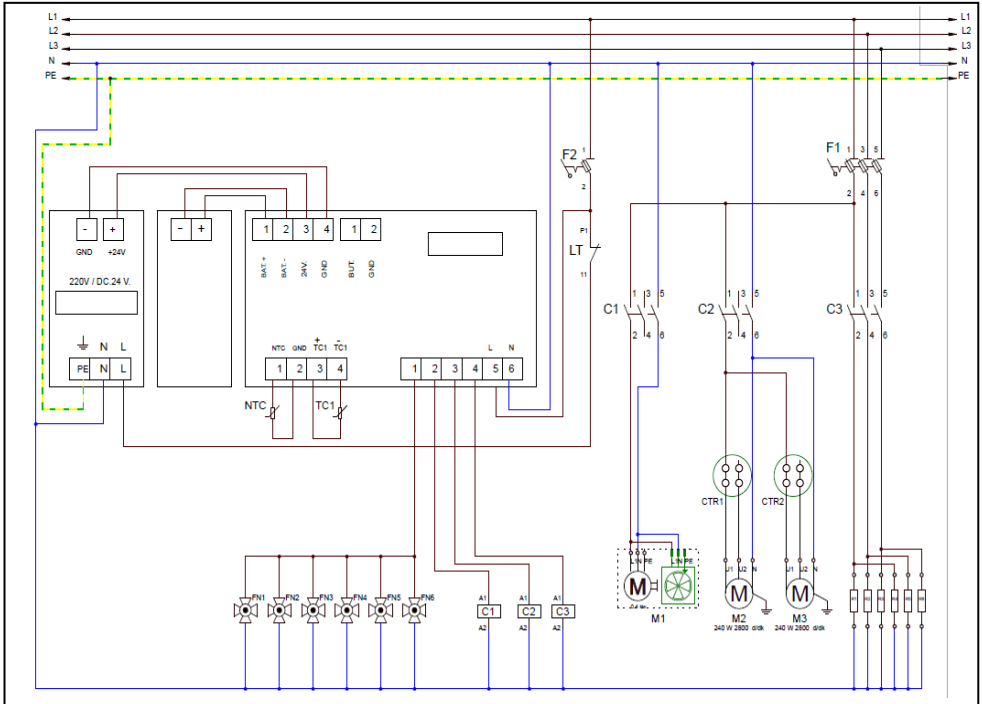

M1	HEATING FAN MOTOR
M2	HEATING FAN MOTOR
R1.R2	RESISTANCE
R3.R4	RESISTANCE
R5.R6	RESISTANCE
CTR1.CTR2	CONDENSER
C1	COOLING GROUP CONTACTOR
C2	HEATING CIRCULATION CONTACTOR
C3	RESISTANCE CONTACTOR
LT	LIMIT THERMOSTAT
F1	RESISTANCE FUSE
F2	CONTROL CIRCUIT FUSE
TC	THERMOCUPL (TC-M06-L0100-K01.J)
FN1.FN2.FN3	COOLING INNER FAN
FN4.FN5.FN6	COOLING INNER FAN