

# THVNR200 230V 50Hz

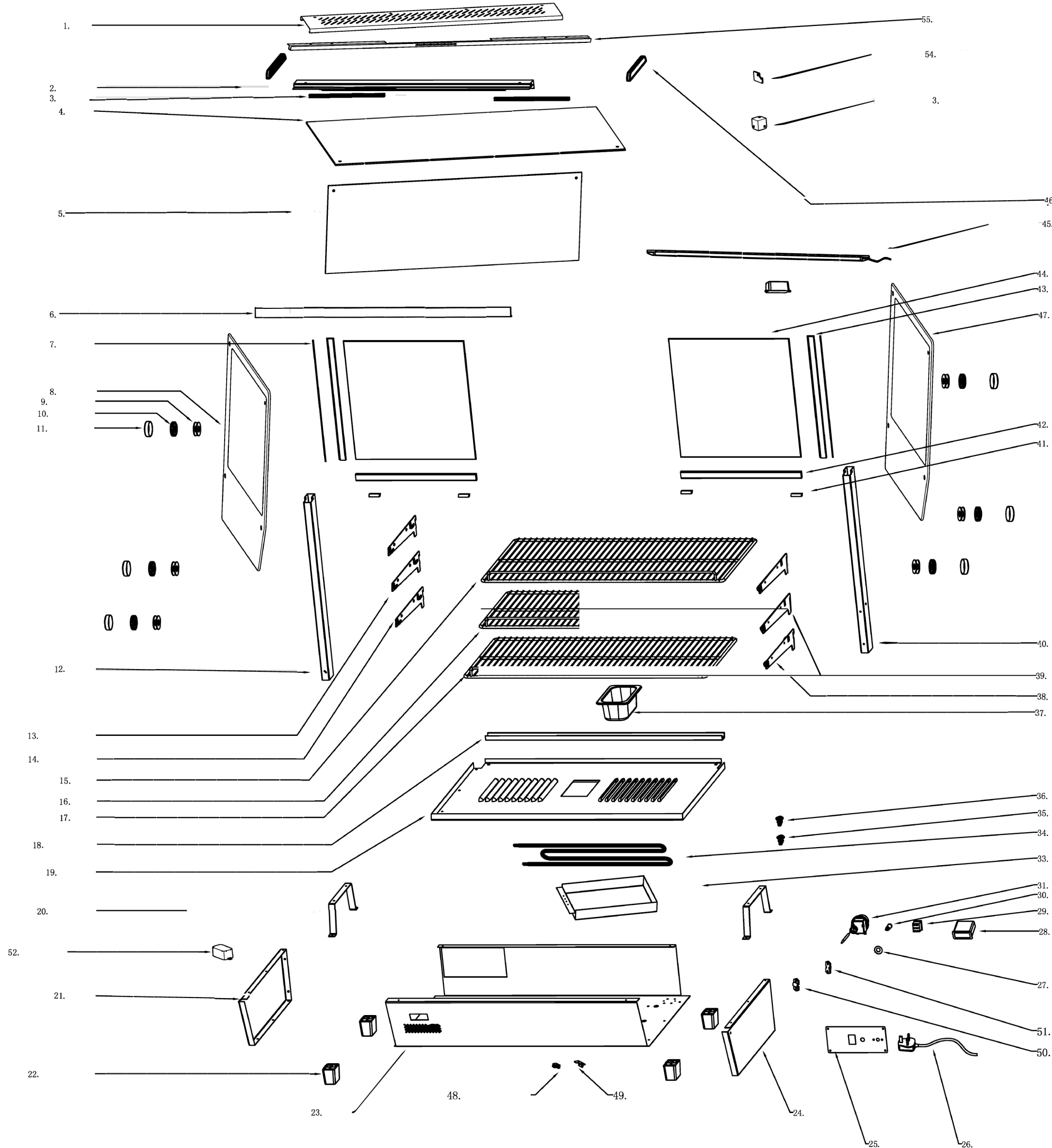

55	1. 1. B151. 07	Probe fixing plate	2. 69
54	1. 1. B. B15. 17	Column gasket	0. 06
53	1. 1. C. C102. 17	Fixed angle	0. 06
52	1. 1. A. A01. 17. 02	Power drive	1. 25
51	1. 1. C. C24. 02	Cable clip base	0. 1
50	1. 1. C. C24. 01	Cable clip cover	0. 1
49	1. 1. B. B93. 02. 42. A1	Fixed plate	0. 4
48	1. 1. B. B78. 99	Steel ingot	0. 4
47	1. 1. E. E2. 12. 236	Right side glass	9. 49
46	1. 1. C. C53. 07	Side board for light cover	0. 14
45	1. 1. A. A01. 14. 116	SMD LED	1. 88
44	1. 1. E. E2. 12. 591	Door glass	2. 09
43	1. 1. B. B14. 20	Door handle	1. 34
42	1. 1. B. B151. 14	Door metal insert	2. 99
41	1. 1. B. B15. 23	Pulley	0. 10
40	1. 1. B. B15. 05	Right pillar	4. 97
39	1. 1. B. B15. 18	Right shelf bracket	1. 44
38	1. 1. B. B15. 19	Bottom right small bracket	1. 13
37	1. 1. B. B15. 20	Water Box	3. 12
36	1. 1. A. A06. 03. 11	Control 150°C	0. 47
35	1. 1. A. A06. 03. 12	Control 125°C	0. 42
34	1. 1. B. B43. 40	V-shaped heating element	11. 7
33	1. 1. B. B151. 08	Chassis of heater	4. 49
31	1. 1. A. A11. 02	Temperature thermostat	2. 86
30	1. 1. A. A11. 04	Indicator light	0. 25
29	1. 1. A. A11. 01	ON/OFF Switch	0. 55
28	1. 1. A. A11. 03	Temperature Display	3. 64
27	1. 1. B. B26. 24	Light gasket	0. 1
26	1. 1. A. A08. 02. 17	Power Cord	2. 3
25	1. 1. B. B151. 02	Control panel	0. 89
24	1. 1. B. B15. 03	Right panel	2. 57
23	1. 1. B. B151. 01	Stainless housing	19. 76
22	1. 1. C. C32. 33	Base feet	0. 19
21	1. 1. B. B15. 02	Left panel	2. 57
20	1. 1. B. B151. 04	Heater brace	1. 66
19	1. 1. B. B151. 05	Radiator bottom plate	10. 76
18	1. 1. B. B151. 16	Sliding door track	5. 22
17	1. 1. B. B151. 12	Chrome shelf 3	10. 55
16	1. 1. B. B151. 11	Chrome shelf 2	10. 46
15	1. 1. B. B151. 10	Chrome shelf 1	10. 39
14	1. 1. B. B25. 27	Bottom left small bracket	1. 13
13	1. 1. B. B25. 26	Left shelf bracket	1. 44
12	1. 1. B. B15. 04	Left pillar	4. 97
11	1. 1. B. B14. 19	Nut Decoration	0. 11
10	1. 1. C. C64. 01	Nut gasket	0. 03
9	1. 1. C. C53. 08	Decoration nut gasket	0. 06
8	1. 1. E. E2. 12. 235	Left Side glass	9. 49
7	1. 1. C. C50. 04	Sealing strip	0. 07
6	1. 1. C. C53. 13	Sealing strip	0. 16
5	1. 1. E. E2. 12. 592	Front glass	5. 1
4	1. 1. E. E2. 12. 593	Top glass	5. 91
3	1. 1. C. C53. 12	Sealing strip	0. 16
2	1. 1. B. B151. 09	Sliding glass track	12. 53
1	1. 1. B. B151. 06	Stainless light cover	7. 73
NO.	Code	Des	Unit price\$